



# Rail product accessories catalogue



## Jointing Tech



**THE POWER TO DELIVER**





## Capability | Your connection point

A high-speed train, possibly a Shinkansen, is shown in motion, blurred to convey speed. The train is white with orange and blue accents. It is traveling on tracks with overhead power lines and pylons. The background is a mix of blue and orange, suggesting a sunset or sunrise. The image is overlaid with a large, semi-transparent white circle containing text.

### **Staying up to date with the latest network approval documents can be time consuming and complicated.**

That's why the Jointing Tech team are on hand to do it for you, saving you time and money on your specialist power projects.

We have an up to date library of product approvals across the power transmission and distribution sectors, drawing on information from the DNO G81 documents, National Grid Asset Codes and Network Rail PADS approvals.

Jointing Tech are the single source for all your LV/MV and HV power cable and accessory materials.

Get in touch today to find out how we can help with your next project!

[www.jointingtech.co.uk](http://www.jointingtech.co.uk)

**THE POWER TO DELIVER**

## Contents

|  |           |   |           |
|--|-----------|---|-----------|
| <b>Cable Glands:</b>                     |           |   |           |
| Stuffing Glands                          | <b>4</b>  | 33kV Indoor/Outdoor Terminations            | <b>25</b> |
| Industrial Glands                        | <b>5</b>  | 11/33kV Indoor Accessories                  | <b>26</b> |
| <b>Cable Lugs &amp; Connectors:</b>      |           | Seperable Connectors                        | <b>27</b> |
| Pre-Insulated Terminals                  | <b>6</b>  | Inner Cone Terminations                     | <b>28</b> |
| LV Lugs                                  | <b>7</b>  | 52kV Heat Shrink                            |           |
| MV Lugs                                  | <b>9</b>  | /Cold Shrink Terminations                   | <b>29</b> |
| MV Mechanical Lugs                       | <b>10</b> | <b>MV Joints:</b>                           |           |
| MV Mechanical Connectors                 | <b>11</b> | 11kV Resin Joints                           | <b>30</b> |
|  |           | 52kV Heat Shrink Joints                     | <b>31</b> |
| <b>Cable Cleats:</b>                     |           | <b>Link Boxes:</b>                          |           |
| Plastic Cable Cleats                     | <b>12</b> | LV 2&4 Way                                  | <b>33</b> |
| Aluminium Cable Cleats                   | <b>13</b> | <b>Earthing &amp; Lightning Protection:</b> |           |
| Stainless Steel Trefoil Cleats           | <b>15</b> | Conductors                                  | <b>34</b> |
| <b>Cable Ties &amp; Marking Systems:</b> |           | Earthing                                    | <b>35</b> |
| Nylon Cable Ties                         | <b>16</b> | Earth Bars                                  | <b>37</b> |
| Stainless Steel Cable Ties               | <b>17</b> | <b>Tapes: PVC Insulation Tapes</b>          | <b>39</b> |
| <b>Insulation Products:</b>              |           | <b>Cable Troughing:</b>                     |           |
| LV Cold Shrink Products                  | <b>19</b> | Lightweight Cable Trough                    | <b>41</b> |
| LV Heat Shrink Products                  | <b>20</b> | <b>Tools &amp; Equipment:</b>               |           |
| <b>LV Joints:</b>                        |           | Hydraulic Press Heads                       | <b>42</b> |
| Resin Joints                             | <b>23</b> | Cable Preparation Tools                     | <b>43</b> |
| <b>MV Terminations:</b>                  |           | <b>Tool &amp; Equipment Hire:</b>           | <b>44</b> |
| 11kV Indoor Terminations                 | <b>24</b> | Consumable Items:                           | <b>46</b> |



**BICON**



**Indoor/outdoor for unarmoured cables**

### FEATURES

- Brass indoor and outdoor cable gland and accessories
- For circular, unarmoured plastic or rubber sheathed cables
- Suitable for most climatic conditions, weatherproof and waterproof
- Kit comprises: A1/A2 gland, brass locknut and shroud
- Available in LSF version
- EN 50262
- BS 6121:Pt 1:1989
- Gland rated to IP66 with use of suitable sealing washer or thread sealant at gland interface
- Service temperature -20°C to +90°C
- CuZn39Pb3 extruded brass alloy used for guaranteed strength and performance

| Part number |                | Size |
|-------------|----------------|------|
| Standard    | LSF            |      |
| A1/A2 20SS  | A1/A2 20SS LSF | 20SS |
| A1/A2 20S   | A1/A2 20S LSF  | 20S  |
| A1/A2 20    | A1/A2 20 LSF   | 20   |
| A1/A2 25    | A1/A2 25 LSF   | 25   |
| A1/A2 32    | A1/A2 32 LSF   | 32   |
| A1/A2 40    | A1/A2 40 LSF   | 40   |

| Part number |               | Size |
|-------------|---------------|------|
| Standard    | LSF           |      |
| A1/A2 50S   | A1/A2 50S LSF | 50S  |
| A1/A2 50    | A1/A2 50 LSF  | 50   |
| A1/A2 63S   | A1/A2 63S LSF | 63S  |
| A1/A2 63    | A1/A2 63 LSF  | 63   |
| A1/A2 75S   | A1/A2 75S LSF | 75S  |
| A1/A2 75    | A1/A2 75 LSF  | 75   |

### Gland Details

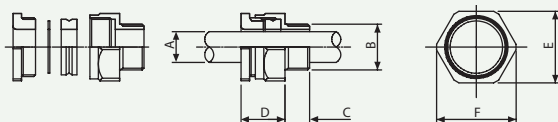

| Size | Cable Dimensions mm<br>Overall Diameter A |      | Gland Dimensions mm |             |   |                   |                     |
|------|---|------|---------------------|-------------|---|-------------------|---------------------|
|      |   |      | Entry Thread        |             | Approx.<br>Length from<br>Shoulder<br>D | Hexagon Size      |                     |
|      | Min                                       | Max  | Size<br>B           | Length<br>C |   | Across Flats<br>E | Across Corners<br>F |
| 20SS | 3.5                                       | 8.5  | M20×1.5             | 10          | 20                                      | 22.0              | 24.9                |
| 20S  | 8.0                                       | 11.5 | M20×1.5             | 10          | 22                                      | 22.0              | 24.9                |
| 20   | 11.0                                      | 13.5 | M20×1.5             | 10          | 22                                      | 24.0              | 26.8                |
| 25   | 13.0                                      | 19.5 | M25×1.5             | 10          | 25                                      | 30.5              | 34.0                |
| 32   | 19.0                                      | 25.5 | M32×1.5             | 10          | 25                                      | 42.4              | 48.0                |
| 40   | 25.0                                      | 32.0 | M40×1.5             | 15          | 33                                      | 47.2              | 53.6                |
| 50S  | 31.5                                      | 37.0 | M50×1.5             | 15          | 30                                      | 55.0              | 60.0                |
| 50   | 36.5                                      | 43.0 | M50×1.5             | 15          | 30                                      | 56.4              | 61.5                |
| 63S  | 42.5                                      | 50.0 | M63×1.5             | 15          | 34                                      | 70.1              | 77.2                |
| 63   | 49.5                                      | 55.0 | M63×1.5             | 15          | 32                                      | 75.0              | 83.0                |
| 75S  | 54.5                                      | 61.0 | M75×1.5             | 15          | 32                                      | 80.0              | 87.4                |
| 75   | 60.5                                      | 67.0 | M75×1.5             | 15          | 40                                      | 85.0              | 95.0                |

Please refer to product selection table on page 38 to size product relative to cable type

## CW Gland Kit - Outdoor Use



Indoor/outdoor type for SWA cable

### FEATURES

- Brass indoor and outdoor cable gland and accessories
- For circular, galvanized-steel single-wire-armour plastic or rubber sheathed cables
- Outer seal grips sheath of cable
- For use in most climatic conditions, weatherproof and waterproof
- Three part armour lock with separate armour locking ring, ideal for checking electrical continuity
- Kit comprises: CW gland, brass earth tag, zinc plated steel locknut and shroud
- Available in LSF version
- EN 50262
- BS 6121:Pt 1:1989
- Gland rated to IP66 with use of suitable sealing washer or thread sealant at gland interface
- Service temperature range -20°C to +90°C
- CuZn39Pb3 extruded brass alloy used for guaranteed strength and performance

| Part number |            | Size |
|-------------|------------|------|
| Standard    | LSF        |      |
| CW20SS      | CW20SS LSF | 20SS |
| CW20S       | CW20S LSF  | 20S  |
| CW20        | CW20 LSF   | 20   |
| CW25        | CW25 LSF   | 25   |
| CW32        | CW32 LSF   | 32   |
| CW40        | CW40 LSF   | 40   |

| Part number |           | Size |
|-------------|-----------|------|
| Standard    | LSF       |      |
| CW50S       | CW50S LSF | 50S  |
| CW50        | CW50 LSF  | 50   |
| CW63        | CW63 LSF  | 63   |
| CW75        | CW75 LSF  | 75   |
| CW85        | CW85 LSF  | 85   |

### Gland Details

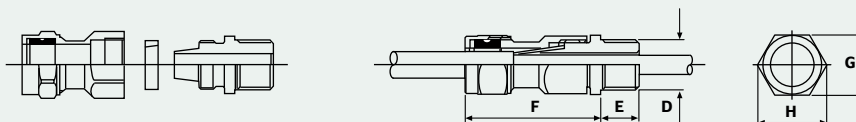

| Size | Cable Dimensions mm       |                  |      |                      | Gland Dimensions mm |          |                                |                |                  |
|------|---------------------------|------------------|------|----------------------|---------------------|----------|--------------------------------|----------------|------------------|
|      | Under Armour Diameter Max | Overall Diameter |      | Armour Wire Diameter | Entry Thread        |          | Approx. Length from Shoulder F | Hexagon Size   |                  |
|      |                           | Min              | Max  |                      | Size D              | Length E |                                | Across Flats G | Across Corners H |
| 20SS | 8.6                       | 8.0              | 13.2 | 0.9                  | M20×1.5             | 10       | 44                             | 23.4           | 26.7             |
| 20S  | 11.6                      | 8.0              | 15.8 | 0.9                  | M20×1.5             | 10       | 46                             | 25.7           | 29.2             |
| 20   | 13.9                      | 11.7             | 20.8 | 0.9/1.25             | M20×1.5             | 10       | 46                             | 30.5           | 34.0             |
| 25   | 19.9                      | 17.0             | 27.2 | 1.25/1.6             | M25×1.5             | 10       | 51                             | 37.6           | 42.2             |
| 32   | 26.2                      | 23.5             | 33.5 | 1.6/2.0              | M32×1.5             | 10       | 56                             | 47.3           | 53.6             |
| 40   | 32.1                      | 29.0             | 39.9 | 1.6/2.0              | M40×1.5             | 15       | 59                             | 56.4           | 61.5             |
| 50S  | 38.1                      | 38.0             | 46.2 | 2.0/2.5              | M50×1.5             | 15       | 64                             | 65.5           | 72.1             |
| 50   | 44.0                      | 39.5             | 52.6 | 2.0/2.5              | M50×1.5             | 15       | 64                             | 70.1           | 77.2             |
| 63   | 55.9                      | 51.3             | 65.3 | 2.5                  | M63×1.5             | 15       | 67                             | 80.0           | 87.4             |
| 75   | 67.9                      | 62.5             | 78.0 | 2.5                  | M75×1.5             | 15       | 76                             | 98.8           | 109.2            |
| 85   | 74.0                      | 68.0             | 88.0 | 3.15                 | M85×2               | 20       | 110                            | 115.0          | 126.0            |

Please refer to product selection table on page 38 to size product relative to cable type

## Ring Terminals

### FEATURES

- Pre-insulated halogen free ring type terminal with funnel entry

| Part number | Colour | Hole Size                    | Conductor Size          |
|-------------|--------|------------------------------|-------------------------|
| RF-M        | Red    | 3, 3.5, 4, 5, 6, 8, 10, 12mm | 0.25-1.5mm <sup>2</sup> |
| BF-M        | Blue   | 3, 3.5, 4, 5, 6, 8, 10, 12mm | 1.5-2.5mm <sup>2</sup>  |
| GF-M        | Yellow | 3.5, 4, 5, 6, 8, 10, 12mm    | 4-6mm <sup>2</sup>      |



## Butt Connectors

### FEATURES

- Pre-insulated straight connectors with funnel entry

| Part number | Colour | Conductor Size          |
|-------------|--------|-------------------------|
| PL03-M      | Red    | 0.25-1.5mm <sup>2</sup> |
| PL06-M      | Blue   | 1.5-2.5mm <sup>2</sup>  |
| PL11-M      | Yellow | 4-6mm <sup>2</sup>      |



## Pin Terminals

### FEATURES

- Pre insulated halogen free pin type terminal with funnel entry

| Part number | Colour | Pin Length   | Conductor Size          |
|-------------|--------|--------------|-------------------------|
| RF-P        | Red    | 8, 10, 12mm  | 0.25-1.5mm <sup>2</sup> |
| BF-P        | Blue   | 8, 10, 12mm  | 1.5-2.5mm <sup>2</sup>  |
| GF-P        | Yellow | 10, 12, 14mm | 4-6mm <sup>2</sup>      |



## Blade Terminals

### FEATURES

- Pre insulated halogen free blade type terminal with funnel entry

| Part number | Colour | Blade Length | Conductor Size          |
|-------------|--------|--------------|-------------------------|
| RF-PP       | Red    | 13, 17mm     | 0.25-1.5mm <sup>2</sup> |
| BF-PP       | Blue   | 13, 17mm     | 1.5-2.5mm <sup>2</sup>  |
| GF-PP       | Yellow | 13, 17mm     | 4-6mm <sup>2</sup>      |



Also available in this range are Fork terminals, male and female disconnect and end sleeves.

## LV Copper Lugs



### FEATURES

- Designed to be crimped on to a conductor to facilitate the termination of the cable via the lug hole
- Copper lugs are electrolytically tin plated to avoid oxidation
- Each terminal has a sight hole for visual inspection of the conductor inserted
- 1000V Rated

### LV copper tube crimping lugs

| Conductor Size |                         |                    |
|----------------|-------------------------|--------------------|
| <b>A03-M</b>   | 3.5, 4, 5, 6mm          | 1.5mm <sup>2</sup> |
| <b>A06-M</b>   | 3.5, 4, 5, 6, 8mm       | 2.5mm <sup>2</sup> |
| <b>A1-M</b>    | 3.5, 4, 5, 6, 8mm       | 4-6mm <sup>2</sup> |
| <b>A2-M</b>    | 3, 4, 5, 6, 8, 10mm     | 10mm <sup>2</sup>  |
| <b>A3-M</b>    | 4, 5, 6, 8, 10, 12mm    | 16mm <sup>2</sup>  |
| <b>A5-M</b>    | 4, 5, 6, 8, 10, 12mm    | 25mm <sup>2</sup>  |
| <b>A7-M</b>    | 5, 6, 8, 10, 12mm       | 35mm <sup>2</sup>  |
| <b>A10-M</b>   | 6, 8, 10, 12, 14, 16mm  | 50mm <sup>2</sup>  |
| <b>A14-M</b>   | 6, 8, 10, 12, 14, 16mm  | 70mm <sup>2</sup>  |
| <b>A19-M</b>   | 8, 10, 12, 14, 16, 20mm | 95mm <sup>2</sup>  |

| Part number   | Hole Size               | Conductor Size      |
|---------------|-------------------------|---------------------|
| <b>A24-M</b>  | 8, 10, 12, 14, 16, 20mm | 120mm <sup>2</sup>  |
| <b>A30-M</b>  | 8, 10, 12, 14, 16, 20mm | 150mm <sup>2</sup>  |
| <b>A37-M</b>  | 8, 10, 12, 14, 16, 20mm | 185mm <sup>2</sup>  |
| <b>A48-M</b>  | 10, 12, 14, 16, 20mm    | 240mm <sup>2</sup>  |
| <b>A60-M</b>  | 10, 12, 14, 16, 20mm    | 300mm <sup>2</sup>  |
| <b>A80-M</b>  | 12, 16, 20mm            | 400mm <sup>2</sup>  |
| <b>A100-M</b> | 16, 20mm                | 500mm <sup>2</sup>  |
| <b>A120-M</b> | 16, 20mm                | 630mm <sup>2</sup>  |
| <b>A160-M</b> | 16, 20mm                | 800mm <sup>2</sup>  |
| <b>A200-M</b> | 16, 20mm                | 1000mm <sup>2</sup> |

## LV Narrow Palm Copper Lugs



### FEATURES

- Designed to be crimped onto a conductor to facilitate the termination of the cable via the lug hole in tight spaces and reduced space terminal blocks
- Copper lugs are electrolytically tin plated to avoid oxidation
- Each terminal has a sight hole for visual inspection of the conductor inserted
- 1000V Rated
- Tested to BS EN 61238

### LV narrow palm copper tube crimping lugs

| Part number    | Palm Width | Hole Size | Conductor Size    |
|----------------|------------|-----------|-------------------|
| <b>BTN10-M</b> | 9mm        | 5mm       | 10mm <sup>2</sup> |
| <b>BTN16-M</b> | 9mm        | 5mm       | 16mm <sup>2</sup> |
| <b>BTN25-M</b> | 9mm        | 5mm       | 25mm <sup>2</sup> |
| <b>BTN35-M</b> | 11.5mm     | 6mm       | 35mm <sup>2</sup> |
| <b>BTN50-M</b> | 11.5mm     | 6mm       | 50mm <sup>2</sup> |
| <b>BTN70-M</b> | 11.5mm     | 6mm       | 70mm <sup>2</sup> |

| Part number     | Palm Width | Hole Size    | Conductor Size     |
|-----------------|------------|--------------|--------------------|
| <b>BTN95-M</b>  | 15.5mm     | 8mm          | 95mm <sup>2</sup>  |
| <b>BTN120-M</b> | 19mm       | 8, 10mm      | 120mm <sup>2</sup> |
| <b>BTN150-M</b> | 19mm       | 8, 10mm      | 150mm <sup>2</sup> |
| <b>BTN185-M</b> | 24.5mm     | 10mm         | 185mm <sup>2</sup> |
| <b>BTN240-M</b> | 31mm       | 10, 12, 16mm | 240mm <sup>2</sup> |
| <b>BTN300-M</b> | 31mm       | 10, 12mm     | 300mm <sup>2</sup> |

## LV 2 Bolt Copper Lugs

### FEATURES

- Designed to facilitate the termination of the cable via two lug holes
- 1000V Rated
- Tested to BS EN 61238



**LV 2 bolt copper tube crimping lugs**

| Part number     | Hole Size | Conductor Size     |
|-----------------|-----------|--------------------|
| <b>A24-2M8</b>  | 2 x 8mm   | 120mm <sup>2</sup> |
| <b>A30-2M12</b> | 2 x 12mm  | 150mm <sup>2</sup> |
| <b>A37-2M12</b> | 2 x 12mm  | 185mm <sup>2</sup> |
| <b>A48-2M12</b> | 2 x 12mm  | 240mm <sup>2</sup> |
| <b>A60-2M12</b> | 2 x 12mm  | 300mm <sup>2</sup> |

| Part number      | Hole Size | Conductor Size     |
|------------------|-----------|--------------------|
| <b>A80-2M12</b>  | 2 x 12mm  | 400mm <sup>2</sup> |
| <b>A100-2M12</b> | 2 x 12mm  | 500mm <sup>2</sup> |
| <b>A120-2M12</b> | 2 x 12mm  | 630mm <sup>2</sup> |
| <b>A160-2M12</b> | 2 x 12mm  | 800mm <sup>2</sup> |

## LV Copper Pin Terminal

### FEATURES

- Designed to be crimped to reduce conductor size for termination into contact blocks
- 1000V Rated
- Tested to BS EN 12449



**LV copper reducing pin terminal**

| Part number   | Pin Diameter | Conductor Size    |
|---------------|--------------|-------------------|
| <b>L10PIN</b> | 3.8mm        | 10mm <sup>2</sup> |
| <b>L16PIN</b> | 3.7mm        | 16mm <sup>2</sup> |
| <b>L25PIN</b> | 5mm          | 25mm <sup>2</sup> |
| <b>L35PIN</b> | 5mm          | 35mm <sup>2</sup> |
| <b>L50PIN</b> | 7.5mm        | 50mm <sup>2</sup> |
| <b>L70PIN</b> | 8mm          | 70mm <sup>2</sup> |
| <b>L95PIN</b> | 8mm          | 95mm <sup>2</sup> |

| Part number    | Pin Diameter | Conductor Size     |
|----------------|--------------|--------------------|
| <b>L120PIN</b> | 10mm         | 120mm <sup>2</sup> |
| <b>L150PIN</b> | 10mm         | 150mm <sup>2</sup> |
| <b>L185PIN</b> | 14mm         | 185mm <sup>2</sup> |
| <b>L240PIN</b> | 14mm         | 240mm <sup>2</sup> |
| <b>L300PIN</b> | 16mm         | 300mm <sup>2</sup> |
| <b>L400PIN</b> | 16mm         | 400mm <sup>2</sup> |

## LV 4 Bolt Copper Lugs

### FEATURES

- Designed to facilitate the termination of a cable on to a transformer
- 1000V Rated
- Tested to BS EN 61238



**LV 4 bolt fixing transformer lugs**

| Part number     | Hole Size | Conductor Size     |
|-----------------|-----------|--------------------|
| <b>A37-4ESI</b> | 4 x 8mm   | 185mm <sup>2</sup> |
| <b>A48-4ESI</b> | 4 x 8mm   | 240mm <sup>2</sup> |
| <b>A60-4ESI</b> | 4 x 8mm   | 300mm <sup>2</sup> |
| <b>A80-4ESI</b> | 4 x 8mm   | 400mm <sup>2</sup> |

| Part number      | Hole Size | Conductor Size      |
|------------------|-----------|---------------------|
| <b>A100-4ESI</b> | 4 x 8mm   | 500mm <sup>2</sup>  |
| <b>A120-4ESI</b> | 4 x 8mm   | 630mm <sup>2</sup>  |
| <b>A160-4ESI</b> | 4 x 8mm   | 800mm <sup>2</sup>  |
| <b>A200-4ESI</b> | 4 x 8mm   | 1000mm <sup>2</sup> |



## MV Copper Lugs



**MV copper tube crimping lugs**

### FEATURES

- Designed to be crimped on to a conductor to facilitate the termination of the cable via the lug hole
- Absence of inspection hold prevents ingress of moisture into crimp
- MV copper lugs are electrolytically tin plated to avoid oxidation
- MV copper lugs have a double length barrel for enhanced electrical & mechanical performance
- 33kV rated
- Tested to BS EN 61238
- UL Listed (up to 300mm<sup>2</sup>)
- DEF Standard 59-71 Approved

| Part number | Size                 | Conductor Size     |
|-------------|----------------------|--------------------|
| 2A3-M       | 8, 10mm              | 16mm <sup>2</sup>  |
| 2A5-M       | 8, 10, 12mm          | 25mm <sup>2</sup>  |
| 2A7-M       | 8, 10, 12mm          | 35mm <sup>2</sup>  |
| 2A10-M      | 10, 12, 14, 16mm     | 50mm <sup>2</sup>  |
| 2A14-M      | 10, 12, 14, 16mm     | 70mm <sup>2</sup>  |
| 2A19-M      | 10, 12, 14, 16, 20mm | 95mm <sup>2</sup>  |
| 2A24-M      | 10, 12, 14, 16, 20mm | 120mm <sup>2</sup> |
| 2A30-M      | 10, 12, 14, 16, 20mm | 150mm <sup>2</sup> |

| Part number | Size             | Conductor Size      |
|-------------|------------------|---------------------|
| 2A37-M      | 12, 14, 16, 20mm | 185mm <sup>2</sup>  |
| 2A48-M      | 12, 14, 16, 20mm | 240mm <sup>2</sup>  |
| 2A60-M      | 12, 14, 16, 20mm | 300mm <sup>2</sup>  |
| 2A80-M      | 12, 14, 16, 20mm | 400mm <sup>2</sup>  |
| 2A100-M     | 16, 20mm         | 500mm <sup>2</sup>  |
| 2A120-M     | 16, 20mm         | 630mm <sup>2</sup>  |
| 2A160-M     | 20mm             | 800mm <sup>2</sup>  |
| 2A200-M     | 20mm             | 1000mm <sup>2</sup> |

## MV 2 Bolt Copper Lugs



**MV 2 bolt copper tube crimping lugs**

### FEATURES

- Designed to be crimped on to a conductor to facilitate the termination of the cable via the two lug holes
- Absence of inspection hold prevents ingress of moisture into crimp
- MV copper lugs are electrolytically tin plated to avoid oxidation
- MV copper lugs have a double length barrel for enhanced electrical and mechanical performance
- 33kV rated
- Tested to BS EN 61238
- UL Listed (up to 300mm<sup>2</sup>)
- DEF Standard 59-71 Approved

| Part number | Hole Size | Conductor Size     |
|-------------|-----------|--------------------|
| CA25-2M     | 8, 12mm   | 25mm <sup>2</sup>  |
| CA35-2M     | 12mm      | 35mm <sup>2</sup>  |
| CA50-2M     | 12mm      | 50mm <sup>2</sup>  |
| CA70-2M     | 12mm      | 70mm <sup>2</sup>  |
| CA95-2M     | 12mm      | 95mm <sup>2</sup>  |
| CA120-2M    | 12mm      | 120mm <sup>2</sup> |
| CA150-2M    | 12mm      | 150mm <sup>2</sup> |

| Part number | Hole Size    | Conductor Size     |
|-------------|--------------|--------------------|
| CA185-2M    | 12mm         | 185mm <sup>2</sup> |
| CA240-2M    | 12mm         | 240mm <sup>2</sup> |
| CA300-2M    | 12mm         | 300mm <sup>2</sup> |
| 2A80-2M     | 12, 14, 16mm | 400mm <sup>2</sup> |
| 2A100-2M    | 14, 16mm     | 500mm <sup>2</sup> |
| 2A120-2M    | 14, 16mm     | 630mm <sup>2</sup> |

## MV Mechanical Lugs - 11-42kV

### FEATURES

- Designed to be connected on to a conductor to facilitate the termination of the cable without the need for crimping
- High tensile tin plated aluminium alloy
- Shear bolt technology to ensure a good electrical connection
- Solid moisture block between palm and barrel
- Smooth profile prevents damage to insulation or sealing sleeves
- No elongation during installation
- Wide application range
- Compact design
- Larger sizes available on request.
- For solid copper and aluminium conductors please contact your nearest sales office
- 42kV Rated



**MV mechanical lug for copper & aluminium conductors**

| Part number         | Stud Size | Conductor Type | Conductor Size         |
|---------------------|-----------|----------------|------------------------|
| <b>BLMT-25/95</b>   | 12, 16mm  | Cu / Ali       | 25-95mm <sup>2</sup>   |
| <b>BLMT-35/150</b>  | 12, 16mm  | Cu / Ali       | 35-150mm <sup>2</sup>  |
| <b>BLMT-95/240</b>  | 12, 16mm  | Cu / Ali       | 95-240mm <sup>2</sup>  |
| <b>BLMT-120/300</b> | 12, 16mm  | Cu / Ali       | 120-300mm <sup>2</sup> |

| Part number         | Stud Size    | Conductor Type | Conductor Size         |
|---------------------|--------------|----------------|------------------------|
| <b>BLMT-185/400</b> | 12, 16, 20mm | Cu / Ali       | 185-400mm <sup>2</sup> |
| <b>BLMT-500/630</b> | 12, 16, 20mm | Cu / Ali       | 500-630mm <sup>2</sup> |
| <b>BLMT-800</b>     | 20mm         | Cu / Ali       | 800mm <sup>2</sup>     |

### Mechanical Lugs Data

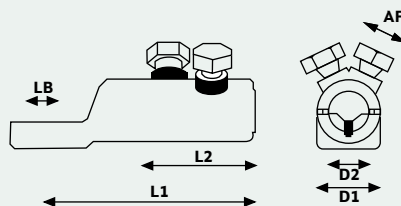

| Part number     | Conductor Range mm <sup>2</sup> | Hole Size mm LB | Dimensions mm |     |    |      | Contact bolts |                 |
|-----------------|---------------------------------|-----------------|---------------|-----|----|------|---------------|-----------------|
|                 |                                 |                 | L1            | L2  | D1 | D2   | Quantity      | Head size AF mm |
| BLMT-25/95-13   | 25-95                           | 13              | 60            | 30  | 24 | 12.8 | 1             | 13              |
| BLMT-25/95-17   | 25-95                           | 17              | 60            | 30  | 24 | 12.8 | 1             | 13              |
| BLMT-35/150-13  | 35-150                          | 13              | 86            | 35  | 28 | 15.8 | 1             | 17              |
| BLMT-35/150-17  | 35-150                          | 17              | 86            | 35  | 28 | 15.8 | 1             | 17              |
| BLMT-95/240-13  | 95-240                          | 13              | 112           | 60  | 33 | 20   | 2             | 19              |
| BLMT-95/240-17  | 95-240                          | 17              | 112           | 60  | 33 | 20   | 2             | 19              |
| BLMT-120/300-13 | 120-300                         | 13              | 115           | 65  | 37 | 24   | 2             | 22              |
| BLMT-120/300-17 | 120-300                         | 17              | 115           | 65  | 37 | 24   | 2             | 22              |
| BLMT-185/400-13 | 185-400                         | 13              | 138           | 80  | 42 | 25.5 | 3             | 22              |
| BLMT-185/400-17 | 185-400                         | 17              | 138           | 80  | 42 | 25.5 | 3             | 22              |
| BLMT-185/400-21 | 185-400                         | 21              | 138           | 80  | 42 | 25.5 | 3             | 22              |
| BLMT-500/630-13 | 500-630                         | 13              | 150           | 95  | 50 | 33   | 3             | 22              |
| BLMT-500/630-17 | 500-630                         | 17              | 150           | 95  | 50 | 33   | 3             | 22              |
| BLMT-500/630-21 | 500-630                         | 21              | 150           | 95  | 50 | 33   | 3             | 22              |
| BLMT-800        | 800                             | 20              | 202           | 120 | 56 | 36   | 4             | 27              |



### MV mechanical connectors for copper & aluminium conductors

#### FEATURES

- Designed to connect two MV conductors inline without the need for crimping
- High tensile tin plated aluminium alloy
- Solid moisture block between conductors
- Conductor size based on circular stranded copper and aluminium
- Torque-controlled shear-head bolts guarantee a good electrical contact
- Easy installation with standard socket spanner
- Pre-engineered design for perfect fit in medium voltage cable accessories up to 42kV
- Tested to IEC61238-1

| Part number         | Conductor Type | Conductor Size         |
|---------------------|----------------|------------------------|
| <b>BSMB-10/35</b>   | Cu / Ali       | 10-35mm <sup>2</sup>   |
| <b>BSM-25/95</b>    | Cu / Ali       | 25-95mm <sup>2</sup>   |
| <b>BSMB-35/150</b>  | Cu / Ali       | 35-150mm <sup>2</sup>  |
| <b>BSM-95/240</b>   | Cu / Ali       | 95-240mm <sup>2</sup>  |
| <b>BSMB-120/300</b> | Cu / Ali       | 120-300mm <sup>2</sup> |

| Part number         | Conductor Type | Conductor Size         |
|---------------------|----------------|------------------------|
| <b>BSM-185/400</b>  | Cu / Ali       | 185-400mm <sup>2</sup> |
| <b>BSMB-500-MK2</b> | Cu / Ali       | 500mm <sup>2</sup>     |
| <b>BSMB-630-MK2</b> | Cu / Ali       | 630mm <sup>2</sup>     |
| <b>BSMB-800-MK2</b> | Cu / Ali       | 800mm <sup>2</sup>     |
| <b>BSMB-1000</b>    | Cu / Ali       | 1000mm <sup>2</sup>    |

#### Mechanical Connectors Data

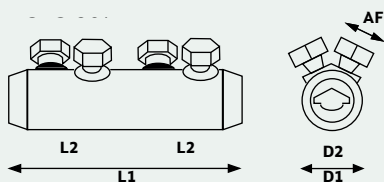

| Part number  | Cross-sectional range mm <sup>2</sup> | Blocked | Dimensions mm |    |    |      |
|--------------|---------------------------------------|---------|---------------|----|----|------|
|              |                                       |         | L1            | L2 | D1 | D2   |
| BSMB-10/35   | 10-35                                 | Yes     | 45            | 20 | 19 | 8.5  |
| BSMB-25/95   | 25-95                                 | Yes     | 65            | 30 | 24 | 12.8 |
| BSMB-35/150  | 35-150                                | Yes     | 80            | 35 | 28 | 15.8 |
| BSM-95/240   | 95-240                                | Yes     | 125           | 60 | 33 | 20   |
| BSMB-120/300 | 120-300                               | Yes     | 140           | 65 | 37 | 24   |
| BSM-185/400  | 185-400                               | Yes     | 170           | 80 | 42 | 25.5 |
| BSMB-500     | 500                                   | Yes     | 160           | 70 | 46 | 30   |
| BSMB-630     | 630                                   | Yes     | 160           | 70 | 50 | 33   |
| BSMB-800     | 800                                   | Yes     | 180           | 85 | 56 | 36   |
| BSMB-1000    | 1000                                  | Yes     | 180           | 85 | 60 | 40   |



## Single and Two Bolt Cleat - LSF

### FEATURES

- Low Smoke Fume (LSF) Product
- Compact mechanical properties offering high impact strength
- Self Extinguishing and flame retardant
- Can be double stacked
- 16 sizes in range
- Operating temperature range -10°C to +120°C
- Two bolt cleats available in red for MV cables



Indoor and outdoor for  
8.5mm to 81mm diameter  
cables

| SINGLE BOLT CLEAT<br>Part Number | Diameter Range |
|----------------------------------|----------------|
| CE00                             | 8.5-11mm       |
| CE0                              | 11-13.5mm      |
| CE1                              | 13.5-16mm      |
| CE2                              | 16-19mm        |
| CE3                              | 19-22mm        |

| TWO BOLT CLEATS |       | Diameter<br>Range |
|-----------------|-------|-------------------|
| Part Number     |       |                   |
| Black           | Red   |                   |
| CE9             | CEH9  | 50-54.5mm         |
| CE10            | CEH10 | 54.5-59mm         |
| CE11            | CEH11 | 59-64mm           |

| SINGLE BOLT CLEAT<br>Part Number | Diameter Range |
|----------------------------------|----------------|
| CE4                              | 22-26.5mm      |
| CE5                              | 26.5-32mm      |
| CE6                              | 32-38mm        |
| CE7                              | 38-44mm        |
| CE8                              | 44-50mm        |

| TWO BOLT CLEATS<br>Part Number |       | Diameter<br>Range |
|--------------------------------|-------|-------------------|
| Black                          | Red   |                   |
| CE12                           | CEH12 | 64-68mm           |
| CE13                           | CEH13 | 68-74mm           |
| CE14                           | CEH14 | 74-81mm           |

### Cable Cleat Details

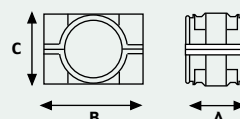
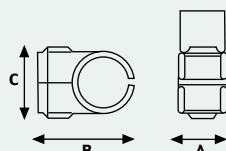

| Part Number | Cable Diameter mm |      | Cleat Dimensions mm |     |    | Approx. Weight g |
|-------------|-------------------|------|---------------------|-----|----|------------------|
|             | Min               | Max  | A                   | B   | C  |                  |
| E00         | 8.5               | 11   | 43                  | 47  | 33 | 34               |
| E0          | 11                | 13.5 | 43                  | 51  | 35 | 37               |
| E1          | 13.5              | 16   | 43                  | 54  | 38 | 42               |
| E2          | 16                | 19   | 43                  | 58  | 41 | 45               |
| E3          | 19                | 22   | 43                  | 60  | 44 | 50               |
| E4          | 22                | 26.5 | 43                  | 64  | 48 | 56               |
| E5          | 26.5              | 32   | 43                  | 70  | 54 | 62               |
| E6          | 32                | 38   | 43                  | 80  | 60 | 79               |
| E7          | 38                | 44   | 43                  | 85  | 66 | 83               |
| E8          | 44                | 50   | 43                  | 88  | 71 | 87               |
| E9          | 50                | 54.5 | 60                  | 97  | 67 | 121              |
| E10         | 54.5              | 59   | 60                  | 97  | 72 | 131              |
| E11         | 59                | 64   | 60                  | 97  | 76 | 145              |
| E12         | 64                | 68   | 60                  | 116 | 80 | 166              |
| E13         | 68                | 74   | 60                  | 116 | 90 | 168              |
| E14         | 74                | 81   | 60                  | 116 | 90 | 188              |

## Single Bolt Claw Cleat

### FEATURES

- High Grade LM6 Aluminium
- Can be used on all types of cable routes
- Available in cast iron to withstand a two hour excursion to 1000°C
- Plain finish-for normal industrial areas or outdoor unpolluted areas
- Epoxy coated version available for harsher environments
- Packing pieces to be used where required
- Two piece, single fixing design
- Single bolt can be stacked to a maximum of three on one fixing
- Available in nine sizes
- Operating temperature -60°C to +105°C

**BI con**

**Indoor/Outdoor for 10mm  
to 51mm diameter cables**

| Part Number     | Diameter Range |
|-----------------|----------------|
| <b>C370BA01</b> | 10-13mm        |
| <b>C370BA02</b> | 13-16mm        |
| <b>C370BA03</b> | 16-19mm        |
| <b>C370BA04</b> | 19-22mm        |
| <b>C370BA05</b> | 22-25mm        |

| Part Number     | Diameter Range |
|-----------------|----------------|
| <b>C370BA06</b> | 25-32mm        |
| <b>C370BA07</b> | 32-38mm        |
| <b>C370BA08</b> | 38-44mm        |
| <b>C370BA09</b> | 44-51mm        |

### Cable Cleat Details

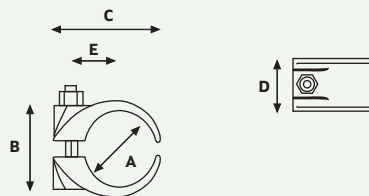

| Table & Cleat Selection |                     |     | Cleat Details |    |    |    |                |           |
|-------------------------|---------------------|-----|---------------|----|----|----|----------------|-----------|
| Part Number             | Cable Diameter A mm |     | Dimensions mm |    |    |    | Approx. Weight | Stud Size |
|                         | Min                 | Max | B             | C  | D  | E  |                |           |
| 370BA01                 | 10                  | 13  | 21            | 38 | 46 | 16 | 60             | M10       |
| 370BA02                 | 13                  | 16  | 21            | 38 | 46 | 16 | 50             | M10       |
| 370BA03                 | 16                  | 19  | 24            | 41 | 46 | 18 | 60             | M10       |
| 370BA04                 | 19                  | 22  | 27            | 44 | 46 | 19 | 70             | M10       |
| 370BA05                 | 22                  | 25  | 30            | 48 | 46 | 21 | 80             | M10       |
| 370BA06                 | 25                  | 32  | 37            | 54 | 46 | 24 | 90             | M10       |
| 370BA07                 | 32                  | 38  | 43            | 60 | 46 | 27 | 110            | M10       |
| 370BA08                 | 38                  | 44  | 49            | 67 | 46 | 30 | 120            | M10       |
| 370BA09                 | 44                  | 51  | 56            | 73 | 46 | 34 | 150            | M10       |

## Two Bolt Cleat

### FEATURES

- High Grade Aluminium LM6
- Two piece, two fixing design
- Can be double stacked on common fixings
- Available in epoxy coated version for more hostile environments
- Tested to BS EN 50368
- Operating temperature -60°C to + 100°C
- Larger sizes have optional rubber liners

BI CON



**Indoor/Outdoor for 51mm to 159mm diameter cables**

| Part Number | Diameter Range |
|-------------|----------------|
| 370BA10     | 51-57mm        |
| 370BA11     | 57-64mm        |
| 370BA12     | 64-70mm        |
| 370BA13     | 70-76mm        |
| 370BA14     | 76-83mm        |
| 370BA15     | 83-89mm        |
| 370BA16     | 89-95mm        |
| 370BA17     | 95-101mm       |
| 370BA18     | 101-108mm      |

| Part Number | Diameter Range |
|-------------|----------------|
| 370BA19     | 108-114mm      |
| 370BA30     | 115-121mm      |
| 370BA31     | 121-127mm      |
| 370BA32     | 127-133mm      |
| 370BA33     | 133-140mm      |
| 370BA34     | 140-146mm      |
| 370BA35     | 146-152mm      |
| 370BA36     | 152-159mm      |

### Cable Cleat Details

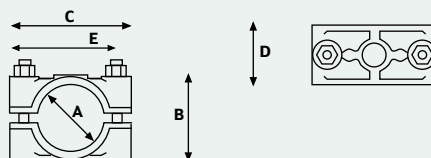

| Table & Cleat Selection |                     |     | Cleat Details |     |     |     |                |           |
|-------------------------|---------------------|-----|---------------|-----|-----|-----|----------------|-----------|
| Design Number           | Cable Diameter A mm |     | Dimensions mm |     |     |     | Approx. Weight | Stud Size |
|                         | Min                 | Max | B Max         | C   | D   | E   |                |           |
| 370BA10                 | 51                  | 57  | 70            | 98  | 49  | 76  | 230            | M10       |
| 370BA11                 | 57                  | 64  | 76            | 98  | 49  | 76  | 240            | M10       |
| 370BA12                 | 64                  | 70  | 82            | 135 | 64  | 114 | 384            | M10       |
| 370BA13                 | 70                  | 76  | 88            | 135 | 64  | 114 | 385            | M10       |
| 370BA14                 | 76                  | 83  | 96            | 140 | 64  | 114 | 420            | M12       |
| 370BA15                 | 83                  | 89  | 101           | 140 | 64  | 114 | 490            | M12       |
| 370BA16                 | 89                  | 95  | 108           | 152 | 76  | 126 | 642            | M12       |
| 370BA17                 | 95                  | 101 | 114           | 152 | 76  | 126 | 642            | M12       |
| 370BA18                 | 101                 | 108 | 120           | 165 | 76  | 140 | 650            | M12       |
| 370BA19                 | 108                 | 114 | 126           | 165 | 76  | 140 | 650            | M12       |
| 370BA30                 | 115                 | 121 | 133           | 175 | 100 | 150 | 734            | M12       |
| 370BA31                 | 121                 | 127 | 139           | 175 | 120 | 150 | 720            | M12       |
| 370BA32                 | 127                 | 133 | 145           | 200 | 120 | 175 | 970            | M12       |
| 370BA33                 | 133                 | 140 | 152           | 200 | 120 | 175 | 956            | M12       |
| 370BA34                 | 140                 | 146 | 158           | 200 | 120 | 175 | 935            | M12       |
| 370BA35                 | 146                 | 152 | 164           | 210 | 120 | 185 | 893            | M12       |
| 370BA36                 | 152                 | 159 | 172           | 215 | 150 | 190 | 1325           | M12       |



**BI CON**



**Indoor/Outdoor for 23mm to 128mm diameter cables**

## FEATURES

- Suitable for cable diameters 23mm to 128mm
- Available in single and double bolt fixing
- Operating temperatures -40°C to +120°C
- Designed to allow easy installation with single tool tightening from the top side
- Manufactured from non-magnetic, corrosion resistant 316L stainless steel
- Cleats are complete with liner made from LSOH material
- Suitable for single core cables laid in trefoil formation with high fault current requirements
- Can be used in harsh environments
- Complies with IEC 61914:2009

| Part Number    | Cable Diameter |
|----------------|----------------|
| <b>379TC01</b> | 23-28mm        |
| <b>379TC02</b> | 27-32mm        |
| <b>379TC03</b> | 30-35mm        |
| <b>379TC04</b> | 33-38mm        |
| <b>379TC05</b> | 36-42mm        |
| <b>379TC06</b> | 40-46mm        |
| <b>379TC07</b> | 44-50mm        |
| <b>379TC08</b> | 48-55mm        |

| Part Number    | Cable Diameter |
|----------------|----------------|
| <b>379TC09</b> | 51-58mm        |
| <b>379TC10</b> | 55-62mm        |
| <b>379TC11</b> | 59-66mm        |
| <b>379TC12</b> | 63-70mm        |
| <b>379TC13</b> | 67-74mm        |
| <b>379TC14</b> | 71-78mm        |
| <b>379TC15</b> | 74-82mm        |

| Part Number    | Cable Diameter |
|----------------|----------------|
| <b>379TC16</b> | 77-85mm        |
| <b>379TC17</b> | 82-88mm        |
| <b>379TC18</b> | 88-96mm        |
| <b>379TC19</b> | 96-103mm       |
| <b>379TC20</b> | 103-111mm      |
| <b>379TC21</b> | 111-119mm      |
| <b>379TC22</b> | 119-128mm      |

## Cable Cleat Details

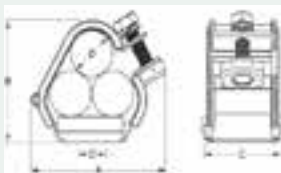

| Cleat Selection |                | Cable Cleat Dimensions (mm) |     |    |             | Weight (g) |
|-----------------|----------------|-----------------------------|-----|----|-------------|------------|
| Part Number     | Cable Diameter | A                           | B   | C  | D           |            |
| 379TC01         | 23-28mm        | 86                          | 71  | 60 | Centre Hole | 500        |
| 379TC02         | 27-32mm        | 92                          | 78  | 60 | 25          | 531        |
| 379TC03         | 30-35mm        | 98                          | 84  | 60 | 25          | 558        |
| 379TC04         | 33-38mm        | 102                         | 90  | 60 | 25          | 585        |
| 379TC05         | 36-42mm        | 108                         | 97  | 60 | 25          | 624        |
| 379TC06         | 40-46mm        | 115                         | 105 | 60 | 25          | 657        |
| 379TC07         | 44-50mm        | 120                         | 112 | 60 | 25          | 693        |
| 379TC08         | 48-55mm        | 129                         | 121 | 60 | 50          | 734        |
| 379TC09         | 51-58mm        | 133                         | 127 | 60 | 50          | 764        |
| 379TC10         | 55-62mm        | 140                         | 134 | 60 | 50          | 795        |
| 379TC11         | 59-66mm        | 145                         | 142 | 60 | 50          | 831        |
| 379TC12         | 63-70mm        | 150                         | 150 | 60 | 50          | 869        |
| 379TC13         | 67-74mm        | 157                         | 157 | 60 | 75          | 905        |
| 379TC14         | 71-78mm        | 164                         | 164 | 60 | 75          | 939        |
| 379TC15         | 74-82mm        | 172                         | 172 | 60 | 75          | 975        |
| 379TC16         | 77-85mm        | 178                         | 178 | 60 | 75          | 1010       |
| 379TC17         | 82-88mm        | 184                         | 184 | 60 | 100         | 1046       |
| 379TC18         | 88-96mm        | 200                         | 198 | 60 | 100         | 1081       |
| 379TC19         | 96-103mm       | 214                         | 210 | 60 | 100         | 1117       |
| 379TC20         | 103-111mm      | 230                         | 225 | 60 | 125         | 1152       |
| 379TC21         | 111-119mm      | 245                         | 240 | 60 | 125         | 1188       |
| 379TC22         | 119-128mm      | 264                         | 257 | 60 | 150         | 1223       |

### Standard Cable Ties

#### FEATURES

- All ties are one-piece moulded mechanisms with bend finger grip tip
- Low threading force with no sharp edges to ensure safe handling and easy installation
- Made with nylon 6'6
- Self-extinguishing
- Operating temperature for LD and MD range -40°C to +85°C
- Operating temperature for HD range -40°C to + 105°C
- Highly resistant against oil, grease, hydrocarbons and alkalis up to 40%



| Part Number                  | Length | Width | Max O/D | Tensile Strength | UOM |
|------------------------------|--------|-------|---------|------------------|-----|
| <b>Light Duty Cable Tie</b>  |        |       |         |                  |     |
| LD06BK                       | 143mm  | 3.6mm | 33mm    | 18.2kg           | 100 |
| LD06WH                       | 143mm  | 3.6mm | 33mm    | 18.2kg           | 100 |
| LD08BK                       | 202mm  | 3.6mm | 50mm    | 18.2kg           | 100 |
| LD08WH                       | 202mm  | 3.6mm | 50mm    | 18.2kg           | 100 |
| LD12BK                       | 303mm  | 3.6mm | 76mm    | 18.2kg           | 100 |
| LD12WH                       | 303mm  | 3.6mm | 76mm    | 18.2kg           | 100 |
| <b>Medium Duty Cable Tie</b> |        |       |         |                  |     |
| MD06BK                       | 160mm  | 4.8mm | 38mm    | 22kg             | 100 |
| MD06WH                       | 160mm  | 4.8mm | 38mm    | 22kg             | 100 |
| MD08BK                       | 202mm  | 4.8mm | 50mm    | 22kg             | 100 |
| MD08WH                       | 202mm  | 4.8mm | 50mm    | 22kg             | 100 |
| MD12BK                       | 280mm  | 4.8mm | 70mm    | 22kg             | 100 |
| MD12WH                       | 280mm  | 4.8mm | 70mm    | 22kg             | 100 |
| MD15BK                       | 370mm  | 4.8mm | 102mm   | 22kg             | 100 |
| MD15WH                       | 370mm  | 4.8mm | 102mm   | 22kg             | 100 |
| <b>Heavy Duty Cable Tie</b>  |        |       |         |                  |     |
| HD12BK                       | 302mm  | 7.6mm | 76mm    | 54kg             | 100 |
| HD12WH                       | 302mm  | 7.6mm | 76mm    | 54kg             | 100 |
| HD15BK                       | 370mm  | 7.6mm | 102mm   | 54kg             | 100 |
| HD15WH                       | 370mm  | 7.6mm | 102mm   | 54kg             | 100 |
| HD21BK                       | 535mm  | 7.6mm | 140mm   | 54kg             | 100 |
| HD21WH                       | 535mm  | 7.6mm | 140mm   | 54kg             | 100 |
| HD30BK                       | 768mm  | 7.6mm | 222mm   | 54kg             | 100 |
| HD30WH                       | 768mm  | 7.6mm | 222mm   | 54kg             | 100 |

### Tie-Lok Ties - Uncoated

#### FEATURES

- Low Profile stainless steel cable ties for use in hazardous area environments
- Operating Temperature - 80°C to + 538°C
- DNV approved
- All available in 316 grade Stainless Steel



**Tie-Lok stainless steel cable ties for cable bundles from 25-254mm**

| Part number | Material      | Size mm   | Bundle Diameter mm | Tensile in N | Pack Quantity |
|-------------|---------------|-----------|--------------------|--------------|---------------|
| AS221       | 304 Grade S/S | 154 x 4.5 | 25                 | 445          | 100           |
| AS222       | 304 Grade S/S | 254 x 4.5 | 51                 | 445          | 100           |
| AS223       | 304 Grade S/S | 406 x 4.5 | 102                | 445          | 100           |
| AS224       | 304 Grade S/S | 572 x 4.5 | 152                | 445          | 100           |
| AS225       | 304 Grade S/S | 737 x 4.5 | 203                | 445          | 100           |

| Part number | Material      | Size mm    | Bundle Diameter mm | Tensile in N | Pack Quantity |
|-------------|---------------|------------|--------------------|--------------|---------------|
| AS211       | 304 Grade S/S | 254 x 6.35 | 51                 | 890          | 100           |
| AS212       | 304 Grade S/S | 419 x 6.35 | 101                | 890          | 100           |
| AS213       | 304 Grade S/S | 572 x 6.35 | 152                | 890          | 100           |
| AS214       | 304 Grade S/S | 737 x 6.35 | 203                | 890          | 100           |
| AS215       | 304 Grade S/S | 889 x 6.35 | 254                | 890          | 100           |

### Multi-Lok Ties - Uncoated

#### FEATURES

- Multi locking stainless steel cable ties for use in hazardous area environments
- Operating Temperature - 80°C to + 538°C
- UL, Lloyd Register, DNV and US Coast Guard approved



**Multi-Lok stainless steel cable ties for cable bundles from 48-193mm**

| Part number | Material      | Size mm | Bundle Diameter mm | Tensile in N | Pack Quantity |
|-------------|---------------|---------|--------------------|--------------|---------------|
| AE601       | 316 Grade S/S | 150 x 7 | 48                 | 890          | 100           |
| AE602       | 316 Grade S/S | 225 x 7 | 71                 | 890          | 100           |
| AE603       | 316 Grade S/S | 300 x 7 | 96                 | 890          | 100           |
| AE604       | 316 Grade S/S | 450 x 7 | 144                | 890          | 100           |
| AE605       | 316 Grade S/S | 610 x 7 | 193                | 890          | 100           |

| Part number | Material      | Size mm  | Bundle Diameter mm | Tensile in N | Pack Quantity |
|-------------|---------------|----------|--------------------|--------------|---------------|
| AE701       | 316 Grade S/S | 150 x 12 | 48                 | 1112         | 100           |
| AE702       | 316 Grade S/S | 225 x 12 | 71                 | 1112         | 100           |
| AE703       | 316 Grade S/S | 300 x 12 | 96                 | 1112         | 100           |
| AE704       | 316 Grade S/S | 450 x 12 | 144                | 1112         | 100           |
| AE705       | 316 Grade S/S | 610 x 12 | 193                | 1112         | 100           |

### Multi-Lok Ties - Coated

#### FEATURES

- Multi locking stainless steel cable ties for use in hazardous area environments
- Nylon 11 black coated to avoid damage to the cable sheaths
- Operating Temperature - 80°C to + 538°C
- UL, Lloyd Register, DNV and US Coast Guard approved



**Coated Multi-Lok stainless steel cable ties for cable bundles from 48-180mm**

| Part number | Material             | Size mm | Bundle Diameter mm | Tensile in N | Pack Quantity |
|-------------|----------------------|---------|--------------------|--------------|---------------|
| AE611       | Coated 316 Grade S/S | 150 x 7 | 33                 | 890          | 100           |
| AE612       | Coated 316 Grade S/S | 225 x 7 | 57                 | 890          | 100           |
| AE613       | Coated 316 Grade S/S | 300 x 7 | 81                 | 890          | 100           |
| AE614       | Coated 316 Grade S/S | 450 x 7 | 129                | 890          | 100           |
| AE615       | Coated 316 Grade S/S | 610 x 7 | 180                | 890          | 100           |

| Part number | Material             | Size mm  | Bundle Diameter mm | Tensile in N | Pack Quantity |
|-------------|----------------------|----------|--------------------|--------------|---------------|
| AE711       | Coated 316 Grade S/S | 150 x 12 | 33                 | 1112         | 100           |
| AE712       | Coated 316 Grade S/S | 225 x 12 | 57                 | 1112         | 100           |
| AE713       | Coated 316 Grade S/S | 300 x 12 | 81                 | 1112         | 100           |
| AE714       | Coated 316 Grade S/S | 450 x 12 | 129                | 1112         | 100           |
| AE715       | Coated 316 Grade S/S | 610 x 12 | 180                | 1112         | 100           |





From Scotland to Southampton,

Carlisle to Croydon,

Newcastle to Newquay

and everywhere in between

Jointing Tech  
offer same day  
dispatch on  
stock orders  
received by  
4pm.



**THE POWER TO DELIVER**

## Cold Shrink Tubes - Network Rail Approved



### Cold Shrink tubes - Network Rail Approved

#### FEATURES

- Approved by Network Rail for terminal insulation and inline joints for track feeder applications
- Improved tough rubber which is suitable for direct burial applications
- Simple installation no external heat source required
- Good thermal stability
- Excellent sealing properties; retaining its resiliency and pressure after prolonged ageing
- Waterproof and resists mould
- Resistant to ozone and UV light
- Resistant to acids and alkali
- Meets worldwide standards ANSI, IEEE, VDE, JCAA, REA & CSA.
- Rated up to 1000V for cable insulation
- Network Rail approved

| Part number | Min Cable Size     | Max Cable Size      | Length |
|-------------|--------------------|---------------------|--------|
| <b>LO41</b> | 240mm <sup>2</sup> | 1000mm <sup>2</sup> | 228mm  |
| <b>LO42</b> | 150mm <sup>2</sup> | 240mm <sup>2</sup>  | 191mm  |

| Part number | Min Cable Size     | Max Cable Size      | Length |
|-------------|--------------------|---------------------|--------|
| <b>LA11</b> | 380mm <sup>2</sup> | 1000mm <sup>2</sup> | 457mm  |

## Cold Shrink End Caps

#### FEATURES

- Designed for the sealing and electrical insulation of cable ends
- Suitable for direct burial applications
- Simple installation no external heat source required
- Good thermal stability
- Excellent sealing properties; retaining its resiliency and pressure after prolonged ageing
- Waterproof and resists mould
- Resistant to ozone and UV light
- Resistant to acids and alkalis
- Accommodates size ranges from 11.6-84.3mm
- Once installed can be removed easily by simply lifting the edge of the end cap and slice with a utility knife leaving no adhesive residue or grease
- Meets worldwide standards ANSI, IEEE, VDE, JCAA, REA & CSA
- Rated up to 1000V for cable insulation
- PADS approved



### Cold Shrink end caps for LV power cables

| Part number | Diameter Range |
|-------------|----------------|
| <b>EC-1</b> | 20.9-11.6mm    |
| <b>EC-2</b> | 30.1-15.9mm    |

| Part number | Diameter Range |
|-------------|----------------|
| <b>EC-3</b> | 49.2-26.0mm    |
| <b>EC-4</b> | 84.3-45.5mm    |

## Thin Wall Heat Shrink Tubing

### FEATURES

- Single wall heat shrink tubing is designed for phase marking, bundling, strain relief and electrical insulation
- Flame retardant and abrasion resistance
- Flexible rapid shrinkage with 2:1 shrink ratio
- UV stabilised
- Other colours available on request (MOQ may apply)
- 1000V rated
- Shrinking temperature > 110°C



**Heat Shrinkable thin wall insulating tubing**

| Part number        | Spool Length | Application Range |
|--------------------|--------------|-------------------|
| <b>HT6.4-3.2</b>   | 100m         | 6-3mm             |
| <b>HT9.5-4.8</b>   | 100m         | 10-5mm            |
| <b>HT12.7-6.4</b>  | 100m         | 12.7-6.4mm        |
| <b>HT19-9.5</b>    | 50m          | 19-10mm           |
| <b>HT25.4-12.7</b> | 50m          | 25-12.5mm         |

| Part number      | Spool Length | Application Range |
|------------------|--------------|-------------------|
| <b>HT38-19</b>   | 50m          | 38-20mm           |
| <b>HT51-25.4</b> | 25m          | 50-25mm           |
| <b>HT76.2-38</b> | 25m          | 76-40mm           |
| <b>HT101-51</b>  | 25m          | 100-50mm          |

## Medium Wall Heat Shrink Tubing

### FEATURES

- Cross linked polyolefin dual wall medium heat shrink tubing is designed for the cable jacketing, sealing and electrical insulation of LV power cables
- Halogen free and resistant to UV light
- Resistant to temperature changes and immune to oils and solvents
- Flexible rapid shrinkage with 3:1 shrink ratio
- Available in 1500mm length as standard
- Available in black only
- Available without internal tubing sealant on request
- 1000V rated
- Shrinking temperature > 110°C
- Tensile strength 14 MPa min
- Dielectric strength > 200kV/cm



**Heat Shrinkable medium wall insulating tubing**

| Part number      | Application Range | Length |
|------------------|-------------------|--------|
| <b>MWTM10/3</b>  | 9-3.5mm           | 1500mm |
| <b>MWTM16/5</b>  | 14-5.5mm          | 1500mm |
| <b>MWTM25/8</b>  | 22-9mm            | 1500mm |
| <b>MWTM35/12</b> | 32-13mm           | 1500mm |
| <b>MWTM50/16</b> | 45-17mm           | 1500mm |
| <b>MWTM63/19</b> | 57-21mm           | 1500mm |
| <b>MWTM75/22</b> | 68-24mm           | 1500mm |

| Part number       | Application Range | Length |
|-------------------|-------------------|--------|
| <b>MWTM85/25</b>  | 76-27mm           | 1500mm |
| <b>MWTM95/29</b>  | 85-31mm           | 1500mm |
| <b>MWTM115/34</b> | 100-36mm          | 1500mm |
| <b>MWTM140/42</b> | 125-44mm          | 1500mm |
| <b>MWTM160/50</b> | 145-52mm          | 1500mm |
| <b>MWTM180/60</b> | 162-62mm          | 1500mm |



## Thick Wall Heat Shrink Tubing



### Heat Shrinkable thick wall insulating tubing

#### FEATURES

- Cross linked polyolefin dual wall thick heat shrink tubing is designed for the cable jacketing, sealing and electrical insulation of LV power cables in underground applications
- The tubings inner co-extruded hot melt adhesive wall gives a dependable moisture seal over most irregular shapes
- Halogen free and resistant to UV light
- Resistant to temperature changes and immune to oils and solvents
- Its mechanical strength enables immediate backfilling of cable trenches after jointing
- Flexible rapid shrinkage with 3:1 shrink ratio
- Available in 1500mm length as standard
- Available in black only
- 1000V rated
- Shrinking temperature > 110C
- Tensile strength 12 MPa min
- Dielectric strength > 170kV/cm

| Part number      | Application Range | Length |
|------------------|-------------------|--------|
| <b>WCSM12/3</b>  | 10-3.5mm          | 1500mm |
| <b>WCSM16/4</b>  | 14-4.5mm          | 1500mm |
| <b>WCSM24/6</b>  | 22-6.5mm          | 1500mm |
| <b>WCSM34/8</b>  | 31-9.0mm          | 1500mm |
| <b>WCSM48/12</b> | 44-13mm           | 1500mm |
| <b>WCSM56/16</b> | 50-17.5mm         | 1500mm |

| Part number       | Application Range | Length |
|-------------------|-------------------|--------|
| <b>WCSM70/20</b>  | 63-22mm           | 1500mm |
| <b>WCSM90/25</b>  | 81-27mm           | 1500mm |
| <b>WCSM110/30</b> | 100-33mm          | 1500mm |
| <b>WCSM130/35</b> | 118-38mm          | 1500mm |
| <b>WCSM160/50</b> | 144-55mm          | 1500mm |
| <b>WCSM180/50</b> | 162-55mm          | 1500mm |

## Heat Shrink Wraparound



### Heat Shrinkable wraparound for cable repairs

#### FEATURES

- Designed to be a fast and permanent cable repair and sealing system for insulation up to 1000V and jacketing applications up to 35kV
- Ideal for repairing long buried cable where it would be impossible to use a tube
- A moisture proof, insulating and tight-fitting repair is then obtained in one step by heating, which makes the sleeve diameter shrink and the adhesive coating melt and flow into the interstices
- Resistant to temperature changes and immune to oils and solvents
- Available in 1500mm lengths as standard and 250mm, 500mm, 750mm and 1000mm on request
- 1000V rated
- Shrinking temperature > 110°C
- Tensile strength 17 MPa min
- Dielectric strength > 180kV/cm

| Part number       | Application Range | Length |
|-------------------|-------------------|--------|
| <b>CRSM34/10</b>  | 21.0-11.0mm       | 1500mm |
| <b>CRSM53/13</b>  | 32.0-17.0mm       | 1500mm |
| <b>CRSM84/20</b>  | 50.0-24.0mm       | 1500mm |
| <b>CRSM107/29</b> | 65.0-31.0mm       | 1500mm |

| Part number       | Application Range | Length |
|-------------------|-------------------|--------|
| <b>CRSM143/36</b> | 86.0-33.0mm       | 1500mm |
| <b>CRSM198/55</b> | 120.0-56.0mm      | 1500mm |
| <b>CRSM250/98</b> | 150.0-103.0mm     | 1500mm |



## Rail | Helping you make the right connection

**Jointing Tech is a specialist electrical distributor supplying a full range of power cable and accessories into the rail industry for substations, feeders, signalling power, civils and construction projects.**

The electrification of the UK rail network has seen Jointing Tech expand its business, supplying a range of Network Rail PADS approved products into 750V DC third rail and 25kV AC projects.

**The Jointing Tech PADS approved product range includes:**

- Cable Glands
- Cable Cleats
- MV Terminations
- Insulation Products
- Power Cables
- Lugs and Connectors
- MV Joints
- Earthing Products
- Tapes & Accessories
- Tool Hire & Sales
- Resin & Compounds
- Cable Troughing

**[www.jointingtech.co.uk](http://www.jointingtech.co.uk)**

**THE POWER TO DELIVER**

## LV Inline Resin Joints Plastic/Paper - Armoured Cables



### Inline resin joints for LV armoured power cables

#### FEATURES

- Designed to connect LV power cables inline by encapsulating in a resin filled shell
- Excellent mechanical protection
- Large transparent, high impact resistant shells
- Large, extra wide shell design allows the use of mechanical connectors
- Clear resin bags to aid with mixing process
- All resin joints kit supplied with NEW REACH compliant JEM resin
- Kit comprises mould shell, JEM resin, earth continuity kit, PVC tapes, gloves and crimp ferrules (on request)
- Mechanical connectors suitable for this range are available on page 26
- 1000V Rated
- Tested to BS EN 50393
- Tested to Engineering Standard C81

| Part number  | Maximum Cable Size         |
|--------------|----------------------------|
| <b>JST6</b>  | 6mm <sup>2</sup> x 4 Core  |
| <b>JST16</b> | 16mm <sup>2</sup> x 4 Core |
| <b>JST35</b> | 35mm <sup>2</sup> x 4 Core |
| <b>JST95</b> | 95mm <sup>2</sup> x 4 Core |

| Part number   | Maximum Cable Size          |
|---------------|-----------------------------|
| <b>JST185</b> | 185mm <sup>2</sup> x 4 Core |
| <b>JST300</b> | 300mm <sup>2</sup> x 4 Core |
| <b>JST400</b> | 400mm <sup>2</sup> x 4 Core |

#### Straight Joints Data

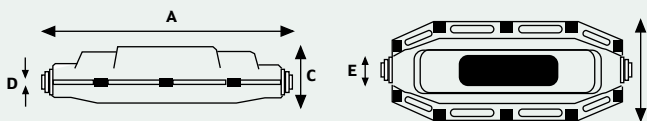

| Part Number | Dimensions mm |     |     |    |    |
|-------------|---------------|-----|-----|----|----|
|             | A             | B   | C   | D  | E  |
| JST6        | 240           | 115 | 75  | 12 | 22 |
| JST16       | 310           | 125 | 85  | 20 | 35 |
| JST35       | 390           | 130 | 100 | 24 | 40 |
| JST95       | 620           | 160 | 130 | 27 | 51 |
| JST185      | 795           | 230 | 205 | 40 | 65 |
| JST300      | 950           | 240 | 210 | 55 | 80 |
| JST400      | 1100          | 275 | 260 | 56 | 92 |

#### Straight Joints Selection Table

| Part Number | Cable conductor size mm <sup>2</sup> |           |           | Cable entry diameter mm |     |
|-------------|--------------------------------------|-----------|-----------|-------------------------|-----|
|             | 2-core                               | 3-core    | 4-core    | Min                     | Max |
| JST6        | 1.5 - 10                             | 1.5 - 6   | 1.5 - 6   | 12                      | 22  |
| JST16       | 16 - 25                              | 10 - 25   | 10 - 16   | 20                      | 35  |
| JST35       | 35                                   | 35        | 25 - 35   | 24                      | 40  |
| JST95       | 50 - 95                              | 50 - 95   | 50 - 95   | 27                      | 51  |
| JST185      | 120 - 185                            | 120 - 185 | 120 - 185 | 40                      | 65  |
| JST300      | 240 - 300                            | 240 - 300 | 240 - 300 | 55                      | 80  |
| JST400      | 400                                  | 400       | 400       | 56                      | 92  |

Please contact your local sales office to join other cable variations

## Single Core Termination with Integral Stress Control for XLPE Cable - Indoor

### FEATURES

- Designed to terminate single core, polymeric insulated 11kV cables in indoor applications to switchgear and cable end boxes
- Suitable for both copper wire and copper tape screen cables
- Highly reliable UK industry standard termination
- Range taking with few components needed
- New ceramic stress control
- Compact design
- No shelf life limitation
- Suitable for use on 11kV triplex cables
- Kit contents: Insulation tubing including co-extruded stress control, sealant tapes and installation instructions
- Tested in accordance with CENELEC specification HD 629.1 and IEC, which encompasses IEC, BS and VDE etc.
- All IXSU/OXSU components have full traceability of raw materials and manufacture according to ISO 9001 and ISO 14001



**Single core heat shrink termination for XLPE cables in indoor applications**

| Part number        | Conductor Size        |
|--------------------|-----------------------|
| <b>IXSU-F-3111</b> | 10-35mm <sup>2</sup>  |
| <b>IXSU-F-3121</b> | 25-95mm <sup>2</sup>  |
| <b>IXSU-F-3131</b> | 95-240mm <sup>2</sup> |

| Part number        | Conductor Size           |
|--------------------|--------------------------|
| <b>IXSU-F-3141</b> | 240-500mm <sup>2</sup>   |
| <b>IXSU-F-3151</b> | 500-800mm <sup>2</sup>   |
| <b>IXSU-F-3161</b> | 1000-1200mm <sup>2</sup> |

## Single Core Termination for XLPE Copper Wire Screened Cables - Indoor

### FEATURES

- Designed to terminate single core, copper wire screened polymeric insulated 11kV cables in indoor applications to switchgear and cable end boxes
- No tools, easy install and ultra lightweight assembly
- Range taking with few components needed
- Inorganic cold shrink silicone insulation
- Kit contents: Termination body and mastic seal
- Tested in accordance CENELEC specification HD629.1 and IEC60502.04 which encompasses the BS, VDE etc.
- Versatile design of the prefabricated one-piece cold shrink termination body allows installation on a wide range of cable sizes and types and a fast and easy installation at temperatures ranging from -20°C to +50°C



**QTIII series single core cold shrink termination for XLPE cables indoor**

| Part number       | Conductor Size         |
|-------------------|------------------------|
| <b>92-EP621-1</b> | 50-95mm <sup>2</sup>   |
| <b>92-EP631-1</b> | 120-400mm <sup>2</sup> |

| Part number       | Conductor Size          |
|-------------------|-------------------------|
| <b>92-EP641-1</b> | 500-630mm <sup>2</sup>  |
| <b>92-EP656-1</b> | 800-1000mm <sup>2</sup> |

## Single Core Termination for XLPE Copper Tape Screen Cables - Indoor/Outdoor



**QTIII series single core cold shrink termination for XLPE copper tape screened cables armoured or lead indoor/outdoor**

### FEATURES

- Designed to terminate single core, copper tape screened polymeric insulated 33kV cables in indoor/outdoor applications to switchgear, cable end boxes and pole top assemblies
- No tools, easy install and ultra lightweight assembly
- One-piece cold shrink termination body allows fast and easy installation
- Installation can be made from -20°C to +50°C
- Cold shrink technology mean the collapsible tubes are all shrink down to the correct limits
- Kit contents: Termination body, earthing kit and mastic seal
- Tested in accordance CENELEC specification HD629.1 which encompasses the BS, VDE etc.

| Part number | Conductor Size        |
|-------------|-----------------------|
| 94-EP612-2  | 50-120mm <sup>2</sup> |
| 94-EP622-2  | 70-240mm <sup>2</sup> |

| Part number | Conductor Size         |
|-------------|------------------------|
| 94-EP632-2  | 185-400mm <sup>2</sup> |
| 94-EP642-2  | 400-630mm <sup>2</sup> |

## Single Core Terminations for Xlpe Cables - Outdoor



**Single core heat shrink termination for XLPE cables in outdoor applications**

### FEATURES

- Designed to terminate single core, polymeric insulated 33kV cables in outdoor applications such as pole top assemblies
- UK industry standard termination
- Outstanding reliability
- Range taking
- Few components needed
- Will accommodate copper wire and copper tape screen
- Simplified cable preparation
- Simplified installation
- Compact design
- No shelf life limitation
- Kit contents: stress control tubings, non tracking sleeve with sealant layer and void filling mastic with installation instructions
- Tested in accordance with CENELEC specification HD 629.1 which encompasses IEC, BS and VDE etc
- Components have full traceability of raw materials and manufacture according to ISO 9001 and ISO 14001

| Part number | Conductor Size         |
|-------------|------------------------|
| EPKT36C1XO  | 50-95mm <sup>2</sup>   |
| EPKT36D1XO  | 120-185mm <sup>2</sup> |

| Part number | Conductor Size          |
|-------------|-------------------------|
| EPKT36E1XO  | 240-500mm <sup>2</sup>  |
| EPKT36F1XO  | 630-1000mm <sup>2</sup> |



## Single Core Armoured Gland



**Aluminium gland kits for single core armoured cable**

### FEATURES

- Aluminium gland kit is designed to electrically earth the aluminium wire armours of the single core cables
- Suitable for use at 11 and 33kV
- Kit contents: three aluminium glands complete with heat shrink sleeve, jubilee clips and bolt pack
- Available with an insulating plate where separate earth facility is required (See insulating kit on page 110)

### Part number

**EAKT1608**

### Conductor Size

50-630mm<sup>2</sup>

## Three Core Armoured Gland



**Steel gland kits for three core armoured cable**

### FEATURES

- Steel gland kit is designed to electrically earth the steel wire armours of the multi-core cables
- Suitable for use at 11 and 33kV
- Kit contains one steel gland complete with either heat shrink or cold shrink sleeve, jubilee clips and bolt pack
- Available with an insulating plate where separate earth facility is required (See page 110)

### Part number

**EAKT1605**

### Conductor Size

up to 70mm<sup>2</sup>

**EAKT1606**

95-300mm<sup>2</sup>

**THG1**

36-65mm (cable OD)

**THG2**

53-94mm (cable OD)

### Part number

**THGS1 (Cold shrink seal)**

### Application Range

To fit THG1

**THGS2 (Cold shrink seal)**

To fit THG2

## Heat Shrink Cable Entry Seal



**Heat shrink glands for unarmoured cables**

### FEATURES

- Designed to provide a heat shrinkable watertight cable entry seal where unarmoured cables enter enclosures
- Manufactured from flame retardant polyolefin
- Temperature rated from -55°C to 90°C
- All cable entry seals are adhesive lined to provide a suitable seal
- Kit contents: a rigid nylon nut, O ring, and a heat shrinkable mould area

### Part number

**CES-1**

### Drill Size

25.4

### Minimum Size Expanded

12.7

### Maximum Size Recovered

4.32

**CES-2**

25.4

19.05

6.35

**CES-3**

35.05

28.45

12.7

**CES-4**

50.8

40.64

19.05

**CES-5**

88.9

69.85

36.32

### Separable Connector System for Bolted Type C (400 Series) Bushing



**Separable connector system for interface C bushing 12-36kV 800A**

#### FEATURES

- Designed to facilitate the easy connection and disconnection of single core copper wire screened XLPE cables to MV transformer and switchgear equipment
- The insulation of the connector is made of a highly modified silicone rubber characterised by high tracking resistance, elongation at break and non flammability
- The screened connector need not be removed for over sheath testing
- The compact design supports the use of double T connections inside standard terminal boxes
- Easily accessible rear plug with capacitive test point
- Available with CU or AL compression lugs or mechanical connectors

| Part Number      | Conductor size         |                        |                        | Core insulation diameter |
|------------------|------------------------|------------------------|------------------------|--------------------------|
|                  | 11kV                   | 24kV                   | 36kV                   |                          |
| <b>RSTI-5851</b> | 35-95mm <sup>2</sup>   | 35-70mm <sup>2</sup>   | -                      | 12.7-23.4mm              |
| <b>RSTI-5852</b> | 95-120mm <sup>2</sup>  | -                      | -                      | 12.7-23.4mm              |
| <b>RSTI-5853</b> | 95-240mm <sup>2</sup>  | 95-185mm <sup>2</sup>  | -                      | 17.0-30.1mm              |
| <b>RSTI-5854</b> | 150-240mm <sup>2</sup> | 95-240mm <sup>2</sup>  | -                      | 21.2-34.6mm              |
| <b>RSTI-5855</b> | 185-300mm <sup>2</sup> | 185-300mm <sup>2</sup> | -                      | 21.2-34.6mm              |
| <b>RSTI-5856</b> | 240-400mm <sup>2</sup> | -                      | -                      | 21.2-34.6mm              |
| <b>RSTI-6851</b> | -                      | -                      | 35-95mm <sup>2</sup>   | 22.4-35.5mm              |
| <b>RSTI-6852</b> | -                      | -                      | 95-150mm <sup>2</sup>  | 22.4-35.5mm              |
| <b>RSTI-6853</b> | -                      | -                      | 120-240mm <sup>2</sup> | 28.9-42.0mm              |
| <b>RSTI-6855</b> | -                      | -                      | 185-300mm <sup>2</sup> | 28.9-42.0mm              |

### Separable Connector Coupling System for Bolted Type C (400 Series) Bushing



**Coupling connector system for interface C bushing 12-36kV 800A**

#### FEATURES

- Angled prefabricated shielded parallel adapter made of silicone rubber, which does not require heat during installation
- Integrated stress control. Separate termination not required
- Three core kits include materials for core screening. Up to 2000mm tail length
- Test point for capacitive voltage measurement
- Mechanical lugs included, compression lugs on request
- Kits include materials for three phases

| Part Number         | Conductor size         |                        |                        | Core insulation diameter |
|---------------------|------------------------|------------------------|------------------------|--------------------------|
|                     | 11kV                   | 24kV                   | 36kV                   |                          |
| <b>RSTI-CC-5851</b> | 35-95mm <sup>2</sup>   | 35-70mm <sup>2</sup>   | -                      | 12.7-23.4mm              |
| <b>RSTI-CC-5852</b> | 95-120mm <sup>2</sup>  | -                      | -                      | 12.7-23.4mm              |
| <b>RSTI-CC-5853</b> | 95-240mm <sup>2</sup>  | 95-185mm <sup>2</sup>  | -                      | 17.0-30.1mm              |
| <b>RSTI-CC-5854</b> | 150-240mm <sup>2</sup> | 95-240mm <sup>2</sup>  | -                      | 21.2-34.6mm              |
| <b>RSTI-CC-5855</b> | 185-300mm <sup>2</sup> | 185-300mm <sup>2</sup> | -                      | 21.2-34.6mm              |
| <b>RSTI-CC-5856</b> | 240-400mm <sup>2</sup> | -                      | -                      | 21.2-34.6mm              |
| <b>RSTI-CC-6851</b> | -                      | -                      | 35-95mm <sup>2</sup>   | 22.4-35.5mm              |
| <b>RSTI-CC-6852</b> | -                      | -                      | 95-150mm <sup>2</sup>  | 22.4-35.5mm              |
| <b>RSTI-CC-6853</b> | -                      | -                      | 120-240mm <sup>2</sup> | 28.9-42.0mm              |
| <b>RSTI-CC-6855</b> | -                      | -                      | 120-300mm <sup>2</sup> | 28.9-42.0mm              |

## Pfisterer Connex Cable Termination System

### FEATURES

- The "Plug In" connector employs an insulated silicone bushing to control the electrical field present when the cable screen is removed
- Heat shrinkable sleeve provides a moisture barrier between the cable sheath and the alloy housing of the connector
- The termination is completed by plugging into the equipment and taking the cable screen to earth
- Sold in sets of three phases
- Installation tooling available to buy or hire (see page xxx and xxx for more information respectively)
- Training courses available
- Designed to meet the requirements of EN 50180, 50181, DIN 47637 and are suitable for all cables to IEC 502 with graphite coated, bonded or "Easy Peel" semi-conducting screens



**Connex Plug in System for size 0, 1, 2, 3, 3S, 4, 5S, 6 & 6S**

| Cone Size | Part number | Max Voltage | Max Current | Cross Section            | Dia Core Insulation | Voltage Tap |
|-----------|-------------|-------------|-------------|--------------------------|---------------------|-------------|
| SIZE 0    | 870-01X-XXX | 12kV        | 250A        | 25-70mm <sup>2</sup>     | 12.0mm - 19.2mm     | NO          |
| SIZE 0    | 870-02X-XXX | 24kV        | 250A        | 25-50mm <sup>2</sup>     | 15.0mm - 23.5mm     | NO          |
| SIZE 1    | 870-11X-XXX | 12kV        | 630A        | 35 - 240mm <sup>2</sup>  | 14.8mm - 28.4mm     | NO          |
| SIZE 1    | 870-12X-XXX | 24kV        | 630A        | 35 - 240mm <sup>2</sup>  | 19.0mm - 32.6mm     | NO          |
| SIZE 1    | 870-13X-XXX | 36kV        | 630A        | 50 - 150mm <sup>2</sup>  | 25.2mm - 33.5mm     | NO          |
| SIZE 1    | 850-11X-XXX | 12kV        | 630A        | 35 - 240mm <sup>2</sup>  | 14.8mm - 28.4mm     | YES         |
| SIZE 1    | 850-12X-XXX | 24kV        | 630A        | 35 - 240mm <sup>2</sup>  | 19.0mm - 32.6mm     | YES         |
| SIZE 1    | 850-13X-XXX | 36kV        | 630A        | 50 - 150mm <sup>2</sup>  | 25.2mm - 33.5mm     | YES         |
| SIZE 2    | 870-21X-XXX | 12kV        | 800A        | 95 - 300mm <sup>2</sup>  | 13.7mm - 30.4mm     | NO          |
| SIZE 2    | 870-22X-XXX | 24kV        | 800A        | 50 - 300mm <sup>2</sup>  | 20.2mm - 34.6mm     | NO          |
| SIZE 2    | 870-23X-XXX | 36kV        | 800A        | 50 - 300mm <sup>2</sup>  | 16.0mm - 38.0mm     | NO          |
| SIZE 2    | 850-21X-XXX | 12kV        | 800A        | 95 - 300mm <sup>2</sup>  | 13.7mm - 30.4mm     | YES         |
| SIZE 2    | 850-22X-XXX | 24kV        | 800A        | 50 - 300mm <sup>2</sup>  | 20.2mm - 34.6mm     | YES         |
| SIZE 2    | 850-23X-XXX | 36kV        | 800A        | 50 - 300mm <sup>2</sup>  | 16.0mm - 38.0mm     | YES         |
| SIZE 3    | 870-31X-XXX | 12kV        | 1250A       | 240 - 630mm <sup>2</sup> | 26.5mm - 39.6mm     | NO          |
| SIZE 3    | 870-32X-XXX | 24kV        | 1250A       | 150 - 630mm <sup>2</sup> | 26.5mm - 45.6mm     | NO          |
| SIZE 3    | 870-33X-XXX | 36kV        | 1250A       | 95 - 630mm <sup>2</sup>  | 28.5mm - 50.0mm     | NO          |
| SIZE 3    | 850-31X-XXX | 12kV        | 1250A       | 240 - 630mm <sup>2</sup> | 26.5mm - 39.6mm     | YES         |
| SIZE 3    | 850-32X-XXX | 24kV        | 1250A       | 150 - 630mm <sup>2</sup> | 26.5mm - 45.6mm     | YES         |
| SIZE 3    | 850-33X-XXX | 36kV        | 1250A       | 95 - 500mm <sup>2</sup>  | 28.5mm - 50.0mm     | YES         |
| SIZE 3S   | 850-350-XXX | 52kV        | 1250A       | 120 - 630mm <sup>2</sup> | 32.0mm - 50.0mm     | NO          |

| Part number | Description           | Info   | For use with cone size |
|-------------|-----------------------|--|------------------------|
| 827-150-005 | Dummy Cable Connector | For Sealing And Voltage Proof Closing Of Connex Connectors | Size 0                 |
| 827-150-002 | Dummy Cable Connector | For Sealing And Voltage Proof Closing Of Connex Connectors | Size 1                 |
| 827-150-003 | Dummy Cable Connector | For Sealing And Voltage Proof Closing Of Connex Connectors | Size 2                 |
| 827-150-004 | Dummy Cable Connector | For Sealing And Voltage Proof Closing Of Connex Connectors | Size 3                 |
| 827-134-004 | Protecting Cap        | For Protecting Withdrawn Connex Connectors Against Dirt    | Size 0                 |
| 827-134-001 | Protecting Cap        | For Protecting Withdrawn Connex Connectors Against Dirt    | Size 1                 |
| 827-134-002 | Protecting Cap        | For Protecting Withdrawn Connex Connectors Against Dirt    | Size 2                 |
| 827-134-003 | Protecting Cap        | For Protecting Withdrawn Connex Connectors Against Dirt    | Size 3                 |

### OHVT Heat Shrink Terminations for XLPE CWS cables

#### FEATURES

- TE Connectivity outdoor termination for trackside applications.
- Supplied without a lug please refer to page...(Complete when Known)
- Compact and modular design
- Water and corrosion resistant
- Different creepage distances available
- Full PADS approval
- Suitable for crimp or mechanical lugs
- Unlimited shelf life under normal storage conditions
- Tested in accordance to IEEE 48 and IEC 60840
- Manufactured according to ISO 9001 and ISO14001



**OHVT Heat Shrink Termination**

| Part number | Cable Size             | Diameter Over Insulation | Termination Length | Creepage Distance | Number of Sheds |
|-------------|------------------------|--------------------------|--------------------|-------------------|-----------------|
| OHVT-5212   | 95-300mm <sup>2</sup>  | 30-45mm                  | 850mm              | 1430mm            | 4               |
| OHVT-5213   | 240-630mm <sup>2</sup> | 38-55mm                  | 850mm              | 1430mm            | 4               |

### 95-EB and 95-EP Cold Shrink Terminations for XLPE CWS cables

#### FEATURES

- The versatile design of the prefabricated one-piece cold shrink termination body allows installation on a wide range of cable sizes and types.
- No heat or flame is needed during installation
- No special tools needed during installation
- Suitable for crimp and mechanical lugs
- Full PADS approval
- Shelf life of QT111 series terminations is specified as three years
- Terminations meet and exceed European standard IEC60840



**Cold Shrink Terminations for XLPE CWS cables**

| Part number | Cable Size            | Diameter Over Insulation | Maximum Diameter Over Lug | Part number | Cable Size             | Diameter Over Insulation | Maximum Diameter Over Lug |
|-------------|-----------------------|--------------------------|---------------------------|-------------|------------------------|--------------------------|---------------------------|
| 95-EB62-2   | 70-400mm <sup>2</sup> | 33.0-53.0mm              | 53mm                      | 95-EP631-2  | 240-400mm <sup>2</sup> | 38.6-51.0mm              | 51mm                      |

## Inline Universal Jointing System for XLPE/PILC/PICAS Three Core Cables

### FEATURES

- Designed to provide a universal system for three core 11kV inline and transition jointing of polymeric or paper cables in one kit.
- Highly reliable UK industry standard joint
- Proven in service with UK REC's since 1991
- 1402 FR resin can be added to this kit for petrochemical environments
- Kit includes: stress control tubes, mechanical connectors, insulating sleeves, armour continuity, plastic shell and two part LDPU resin
- Tested in accordance with CENELEC specification HD 629 or IEC 60502-4 for joints



**Shrinkset - Inline universal jointing system for any combination of three core XLPE/PILC/PICAS cables**

| Part number             | Conductor Size   | To Suit            | Resin Volume |
|-------------------------|--|--------------------|--------------|
| <b>SHSS-12A-IND</b>     | 35-185mm <sup>2</sup> Poly - 70-185mm <sup>2</sup> Paper   | -                  | 14 litres    |
| <b>SHSS-12B-IND</b>     | 185-300mm <sup>2</sup> Poly - 185-300mm <sup>2</sup> Paper | -                  | 28 litres    |
| <b>BU1 - SMOE 61745</b> | 16-25mm <sup>2</sup> Poly - 16-50mm <sup>2</sup> Paper     | Use with SHSS-12-A | -            |
| <b>BU2 - SMOE 61760</b> | 95-150mm <sup>2</sup> Poly - 95-150mm <sup>2</sup> Paper   | Use with SHSS-12-B | -            |
| <b>BU3 - SMOE 61798</b> | 16-70mm <sup>2</sup> Poly - 16-70mm <sup>2</sup> Paper     | Use with SHSS-12-B | -            |

## Inline Joints for Three Core Armoured XLPE/PILC/PICAS Cables

### FEATURES

- The versatile design of the prefabricated one-piece cold shrink splice body allows installation on a wide range of cable sizes and types and a fast and easy installation at temperatures ranging from -20 to +50°C
- No heat or flame needed during splice body installation
- Mechanical connectors provide quick and easy installation
- No special tools are needed during splice installation
- Thick walled EPDM rubber cold shrink outer re-jacketing tubes provide mechanical protection and moisture sealing of the completed inline joints
- Outer protection using Scotchcast resin provides options to install in zones 1 and 2 hazardous areas, as well as protection for PILC/PICAS cables
- Different sized cables can be joined using build up kits



**Cold Shrink joint to join any combination of three core cables**

| Part number                   | Joint Type                | Outer Protection | Conductor Size         |
|-------------------------------|---------------------------|------------------|------------------------|
| <b>92-AV610-3/C</b>           | XLPE Straight             | See below        | 50-120mm <sup>2</sup>  |
| <b>92-AV620-3/C</b>           | XLPE Straight             | See below        | 150-240mm <sup>2</sup> |
| <b>92-AV630-3/C</b>           | XLPE Straight             | See below        | 240-400mm <sup>2</sup> |
| <b>92-AV610-3/C+1 x PILC1</b> | XLPE to PILC/PICAS        | See below        | 50-120mm <sup>2</sup>  |
| <b>92-AV620-3/C+1 x PILC2</b> | XLPE to PILC/PICAS        | See below        | 150-240mm <sup>2</sup> |
| <b>92-AV630-3/C+1 x PILC3</b> | XLPE to PILC/PICAS        | See below        | 240-400mm <sup>2</sup> |
| <b>92-AV610-3/C+2 x PILC1</b> | PILC/PICAS Straight Joint | See below        | 50-120mm <sup>2</sup>  |
| <b>92-AV620-3/C+2 x PILC2</b> | PILC/PICAS Straight Joint | See below        | 150-240mm <sup>2</sup> |
| <b>92-AV630-3/C+2 x PILC3</b> | PILC/PICAS Straight Joint | See below        | 240-400mm <sup>2</sup> |

### Outer Protection Sleeve/Shell

| Part number    | Protection Type  | To Suit                     | Resin Volume |
|----------------|------------------|-----------------------------|--------------|
| <b>CS610-3</b> | Cold Shrink Tube | 92-AV610-3/C                | -            |
| <b>CS620-3</b> | Cold Shrink Tube | 92-AV620-3/C                | -            |
| <b>CS630-3</b> | Cold Shrink Tube | 92-AV630-3/C                | -            |
| <b>1451</b>    | Moulded Shell    | 92-AV610-3/C & 92-AV620-3/C | 14 litres    |
| <b>1452</b>    | Moulded Shell    | 92-AV630-3/C                | 21 litres    |





## Heat Shrink Inline Joints



### 52kV Heat Shrink Inline Joint

#### FEATURES

- Designed to join inline single core 52kV unarmoured cables
- Range taking design
- Unlimited shelf life
- Designed for use with mechanical connectors
- Kit includes: Stress control tubes, Insulating sleeves, mastics and outer protection sleeve
- Network Rail approved
- Available for size and insulation transition.
- Cable joints for cross bonding/shield break applications also available
- Tested to IEEE 404 1993, EDF HN-68-S-20, SEN 24 1434, ESI 09-16 & IEC840

| Part number   | Description   | Cable size             | Diameter over insulation |
|---|---|------------------------|--------------------------|
| <b>EHVS-52H-1-W-1D</b>  | 25/44kV Poly/Poly Straight Joint, excluding connector | 95-300mm <sup>2</sup>  | 30-45mm                  |
| <b>EHVS-52H-1-W-2D</b>  | 25/44kV Poly/Poly Straight Joint, excluding connector | 300-630mm <sup>2</sup> | 42-55mm                  |
| Cable specification must be supplied with cable dimensions at time of order |   |                        |                          |



## Cold Shrink QS III Splicing Kit



### Cold Shrink QS III Splicing Kit

#### FEATURES

- Designed to join inline single core 52kV unarmoured cables
- No heat or flame is needed during installation
- Designed for use with mechanical connectors (included)
- One piece splice body
- Network Rail approved
- Tested to IEC60502-04

| Partnumber  | Description   | Cable size             | Diameter over insulation |
|---|---|------------------------|--------------------------|
| <b>95-AC645-1-240/C</b>   | 25/44kV Poly/Poly Straight Joint, excluding connector | 120-240mm <sup>2</sup> | 31.5-53.8mm              |
| <b>95-AC645-1-400/C</b>   | 25/44kV Poly/Poly Straight Joint, excluding connector | 300-400mm <sup>2</sup> | 31.5-53.8mm              |
| Cable specification must be supplied with cable dimensions at time of order |   |                        |                          |

## Renewables | Working with nature to supply your power

**Jointing Tech is a specialist electrical distributor supplying a full range of power cable and accessories into the renewable energy sector.**

**The Jointing Tech range includes:**

- Distribution Transformers
- Switchgear
- Earthing (inc HDC Cable)
- MV Joints
- MV Terminations
- MV Power Cable
- Earthing Design
- Installation
- Lugs & Connectors
- Tool hire & Sales

We are all working to reduce our carbon footprint to make our environment as green as possible. Jointing Tech are leading the way to help you achieve this.

[www.jointingtech.co.uk](http://www.jointingtech.co.uk)

**THE POWER TO DELIVER**

## LV 2 & 4 Way Link Boxes

### FEATURES

- Can be jointed directly onto polymeric or paper insulated LV cables eliminating the need for intermediate lengths of polymeric cables and straight/transition joints
- Pre-fitted factory tailed units are available to speed up direct replacement installations
- Both 3 and 4 core variants are available
- All below are tested to BS EN50393 & 60947-1 and ER C81/4
- Pit frame and colour meet B125 EN124 standards



| Description                                   | Conductor Range       | Weight |
|---|-----------------------|--------|
| 2 way 3-Core MK3 Link Box                     | 70-300mm <sup>2</sup> | 39kg   |
| 4 way 3-Core MK3 Link Box                     | 70-300mm <sup>2</sup> | 100kg  |
| 2 way multicable MK3 Link Box                 | 70-300mm <sup>2</sup> | 42kg   |
| 2 way 3-Core MK3 Link Box double bolt version | 70-300mm <sup>2</sup> | 39kg   |
| 4 way 3-Core MK3 Link Box double bolt version | 70-300mm <sup>2</sup> | 100kg  |
| 2 way 3&4-Core Untailed MK3 Link Box          | 70-300mm <sup>2</sup> | 40kg   |
| 4 way 3&4-Core Untailed MK3 Link Box          | 70-300mm <sup>2</sup> | 102kg  |

| Accessories                       | Accessories                              |
|-----------------------------------|--|
| Wedge type links (83mm centres)   | Pavement frame and cover (300mm x 300mm) |
| Insulated link remover (single)   | Pavement frame and cover (600mm x 450mm) |
| Insulated link remover (multiple) | Pavement cover lifting keys              |

## Bare Copper Tape

### FEATURES

- Designed for use as conductor in earthing and lightning protection systems
- Conductor size determined by application and expected fault current
- Other sizes available on request
- High conductivity copper tape to BS EN 13601 (formerly BS 1432)
- UL 96 (TC030-UL, TC040-UL, TC080)
- Other coil sizes available
- Stamped tape available on request, e.g. 'National Grid'



| Part number  | Size   | Weight per metre | Coil Size |
|--------------|--------|------------------|-----------|
| <b>TC030</b> | 25x3mm | 0.67kg           | 25m       |
| <b>TC040</b> | 25x6mm | 1.33kg           | 40m       |
| <b>TC065</b> | 38x6mm | 2.02kg           | 25m       |

| Part number  | Size   | Weight per metre | Coil Size |
|--------------|--------|------------------|-----------|
| <b>TC066</b> | 40x4mm | 1.42kg           | 30m       |
| <b>TC075</b> | 50x4mm | 1.78kg           | 30m       |
| <b>TC080</b> | 50x6mm | 2.68kg           | 20m       |

## PVC Covered Copper Tape

### FEATURES

- Designed for use as conductor in earthing and lightning protection systems
- Conductor size determined by application and expected fault current
- Available in six colours
- High conductivity copper tape to BS EN 13601 (formerly BS 1432)
- PVC colours to BS 5252. \* Green to BS 6746C



| Part number     | Colour | Size   | Weight per metre | Coil Size |
|-----------------|--------|--------|------------------|-----------|
| <b>TC105-FU</b> | Black  | 25x3mm | 0.77kg           | 25m       |
| <b>TC110</b>    | Green  | 25x3mm | 0.77kg           | 25m       |
| <b>TC115-FU</b> | Grey   | 25x3mm | 0.77kg           | 25m       |
| <b>TC120-FU</b> | Stone  | 25x3mm | 0.77kg           | 25m       |

| Part number     | Colour | Size   | Weight per metre | Coil Size |
|-----------------|--------|--------|------------------|-----------|
| <b>TC125-FU</b> | White  | 25x3mm | 0.77kg           | 25m       |
| <b>TC130</b>    | Brown  | 25x3mm | 0.77kg           | 25m       |
| <b>TC140-FU</b> | Green  | 25x6mm | 1.53kg           | 40m       |
| <b>TC145</b>    | Green  | 50x6mm | 2.95kg           | 20m       |

## Green & Yellow PVC Insulated Copper Tape

### FEATURES

- Designed for use as conductor in earthing and lightning protection systems
- Conductor size determined by application and expected fault current
- High conductivity copper tape to BS EN 13601 (formerly BS 1432)
- PVC colours to BS 5252.



| Part number     | Colour         | Size   | Weight per metre | Coil Size |
|-----------------|----------------|--------|------------------|-----------|
| <b>TC111-FU</b> | Green & Yellow | 25x3mm | 0.79kg           | 25m       |

## Copperbond Earth Rods



### FEATURES

- Designed to be driven into the ground to provide a low resistance to earth for the interconnected lightning protection system
- Manufactured by molecularly bonding 99.9% copper on to a low carbon steel core
- Copper thickness minimum 250 microns
- BS EN 50164-2, BS 7430

| Part number     | Material   | Size          | Weight each |
|-----------------|------------|---------------|-------------|
| <b>RB205-FU</b> | Copperbond | 5/8" x 1200mm | 1.53kg      |
| <b>RB210</b>    | Copperbond | 5/8" x 1500mm | 1.88kg      |
| <b>RB215</b>    | Copperbond | 5/8" x 1800mm | 2.29kg      |
| <b>RB220-FU</b> | Copperbond | 5/8" x 2100mm | 2.51kg      |
| <b>RB225</b>    | Copperbond | 5/8" x 2400mm | 3.00kg      |
| <b>RB235</b>    | Copperbond | 5/8" x 3000mm | 3.79kg      |

| Part number     | Material   | Size          | Weight each |
|-----------------|------------|---------------|-------------|
| <b>RB305</b>    | Copperbond | 3/4" x 1200mm | 2.19kg      |
| <b>RB310</b>    | Copperbond | 3/4" x 1500mm | 3.27kg      |
| <b>RB320-FU</b> | Copperbond | 3/4" x 2100mm | 3.83kg      |
| <b>RB325</b>    | Copperbond | 3/4" x 2400mm | 4.35kg      |
| <b>RB335</b>    | Copperbond | 3/4" x 3000mm | 5.44kg      |

## Coupling



### FEATURES

- Designed to interconnect earth rods to enable earth rod assembly to be driven deeper to lower resistance
- Manufactured from high copper content alloy
- Excellent resistance to corrosion
- BS EN 50164-1

| Part number  | Material | Size | Weight each |
|--------------|----------|------|-------------|
| <b>CG270</b> | Copper   | 5/8" | 0.08kg      |

| Part number  | Material | Size | Weight each |
|--------------|----------|------|-------------|
| <b>CG370</b> | Copper   | 3/4" | 0.13kg      |

## Driving Stud



### FEATURES

- Designed to be used in conjunction with a coupling to drive the earth rod into the ground and avoid damaging the threads of the rod
- Manufactured from carbon steel
- BS EN 50164-1

| Part number   | Material | Size | Weight each |
|---------------|----------|------|-------------|
| <b>DST200</b> | Steel    | 5/8" | 0.08kg      |

| Part number   | Material | Size | Weight each |
|---------------|----------|------|-------------|
| <b>DST300</b> | Steel    | 3/4" | 0.12kg      |



## Earth Plates - Lattice & Solid Copper

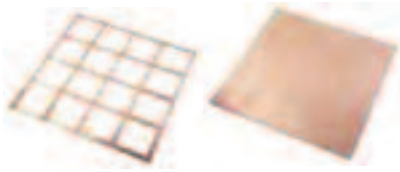

### FEATURES

- Designed to be buried in the ground to provide a low resistance to earth for the interconnected lightning protection system
- Manufactured from high conductivity copper
- Available in either solid or lattice copper
- Lattice to BS EN 13601
- Solid copper to BS EN 12163

| Part number  | Description | Size            | Weight each |
|--------------|-------------|-----------------|-------------|
| <b>PE110</b> | Lattice     | 600 x 600 x 3mm | 3.98kg      |
| <b>PE120</b> | Lattice     | 900 x 900 x 3mm | 7.20kg      |

| Part number  | Description  | Size            | Weight each |
|--------------|--------------|-----------------|-------------|
| <b>PE010</b> | Solid Copper | 600 x 600 x 3mm | 9.74kg      |
| <b>PE020</b> | Solid copper | 900 x 900 x 3mm | 21.74kg     |

## Marconite



### FEATURES

- Designed to be added in place of sand and aggregate to cement to provide a conductive aggregate which lowers the resistance to earth.
- When used as a backfill for earth electrodes marconite impregnated concrete greatly increases the electrode's surface area.
- Ideal for poor ground conditions where low resistances are problematical
- A permanent solution that doesn't dry out like moisture retaining clay in inclement weather conditions
- Available in powder and granules
- Please contact Jointing Tech to calculate quantity of materials required using Backfill software

| Part number      | Type   | Weight |
|------------------|--------|--------|
| <b>MARCONITE</b> | Powder | 25kg   |

| Part number         | Type     | Weight |
|---------------------|----------|--------|
| <b>MARCONITE-PM</b> | Granules | 25kg   |

## Bentonite



### FEATURES

- Designed to be mixed with water to produce a moisture retaining clay which lowers the resistance to earth
- The clay is a sodium activated montmorillonite which when mixed with water swells to many times its dry volume
- Bentonite has the ability to hold moisture content for a considerable period of time and absorb moisture from the surrounding area
- Ideal for poor ground conditions where low resistances are problematical
- Available in powder and granules
- Contact your nearest sales office and using the Furse Backfill software we will advise on the quantity required for each installation

| Part number  | Type   | Weight each |
|--------------|--------|-------------|
| <b>CM015</b> | Powder | 25kg        |

| Part number     | Type     | Weight each |
|-----------------|----------|-------------|
| <b>CM015-PM</b> | Granules | 25kg        |

## Earth Bars



### FEATURES

- Earth Bars are an efficient and convenient way of providing a common earth point with integral disconnecting links which facilitate easy isolation for testing purposes
- Manufactured out of high conductivity 50x6mm HD copper bar
- The PVC channel base is entirely corrosion proof - made with high impact uPVC unlike the traditional galvanised steel channel
- Lighter and easier to handle - the use of a modern polymer channel has reduced the weight of the product making it easier to handle
- M10 phosphor bronze stud assemblies
- Pre-drilled holes for ease of installation
- A range of four designs to meet most installation requirements
- Custom made earth bar service available

## Standard Earth Bar



### FEATURES

- A standard earth bar to facilitate multiple connections to earth

| Part number | No. of Ways | Stud | Size            | Weight each |
|-------------|-------------|------|-----------------|-------------|
| LK245-4     | 4           | M10  | 300 x 90 x 90mm | 1.4kg       |
| LK245-6     | 6           | M10  | 400 x 90 x 90mm | 1.80kg      |
| LK245-8     | 8           | M10  | 500 x 90 x 90mm | 2.20kg      |
| LK245-10    | 10          | M10  | 650 x 90 x 90mm | 2.80kg      |
| LK245-12    | 12          | M10  | 750 x 90 x 90mm | 3.20kg      |

| Part number | No. of Ways | Stud | Size             | Weight each |
|-------------|-------------|------|------------------|-------------|
| LK245-16    | 16          | M10  | 950 x 90 x 90mm  | 4.00kg      |
| LK245-20    | 20          | M10  | 1200 x 90 x 90mm | 5.00kg      |
| LK245-24    | 24          | M10  | 1400 x 90 x 90mm | 5.80kg      |
| LK245-28    | 28          | M10  | 1650 x 90 x 90mm | 6.90kg      |

## Earth Bar with Single Disconnecting Link



### FEATURES

- An earth bar with single disconnecting link to facilitate multiple connections to earth with the option of isolating for testing purposes

| Part number | No. of Ways | Stud | Size            | Weight each |
|-------------|-------------|------|-----------------|-------------|
| LK243-4     | 4           | M10  | 375 x 90 x 96mm | 1.9kg       |
| LK243-6     | 6           | M10  | 475 x 90 x 96mm | 2.30kg      |
| LK243-8     | 8           | M10  | 575 x 90 x 96mm | 2.70kg      |
| LK243-10    | 10          | M10  | 725 x 90 x 96mm | 3.30kg      |
| LK243-12    | 12          | M10  | 825 x 90 x 96mm | 3.70kg      |

| Part number | No. of Ways | Stud | Size             | Weight each |
|-------------|-------------|------|------------------|-------------|
| LK243-16    | 16          | M10  | 1025 x 90 x 96mm | 4.50kg      |
| LK243-20    | 20          | M10  | 1275 x 90 x 96mm | 5.50kg      |
| LK243-24    | 24          | M10  | 1475 x 90 x 96mm | 6.30kg      |
| LK243-28    | 28          | M10  | 1725 x 90 x 96mm | 7.40kg      |



## We're Here to Help You!



Need technical assistance or advice on site, support with the latest documentation or simply product selection, the team at Jointing Tech are always on hand to help you with your projects.

With branches throughout the UK there is always someone close by that can help you.

Our knowledgeable team have hundreds of years combined experience and are confident that no matter what your project needs we will be able to advise and support you.

Simply pick up the phone and call your nearest branch today or send an enquiry through our website.

[www.jointingtech.co.uk](http://www.jointingtech.co.uk)

## Scotch Super 33+ Tape



**Premium grade all weather PVC insulating tape**

### FEATURES

- Designed for primary electrical insulation for cable splices and busbar applications
- All weather tape suitable for cold weather applications
- Flame retardant and highly conformable
- Excellent resistance to abrasion, moisture, alkalis, acid, copper corrosion.
- Provides protective jacketing for HV cable splices and repairs (up to 600V)
- Conforms to BS 3924 and UL 510
- Temperature rating - 18°C to 105°C

| Part Number | Material | Colour | Size           | Coil size |
|-------------|----------|--------|----------------|-----------|
| SCOTCH33+   | PVC      | Black  | 19mm x 0.178mm | 20m       |

## Scotch Super 88 Tape



**Premium grade heavy duty all weather PVC tape**

### FEATURES

- Designed for primary electrical insulation for cable splices and busbar applications
- Excellent abrasion and puncture resistance
- All weather tape suitable for cold weather applications
- Flame retardant and highly conformable
- Excellent resistance to moisture, alkalis, acid, copper corrosion
- Provides protective jacketing for HV cable splices and repairs (up to 600V)
- Conforms to BS 3924 and UL 510
- Temperature rating -18°C to +105°C

| Part Number | Material | Colour | Size           | Coil size |
|-------------|----------|--------|----------------|-----------|
| SCOTCH88-19 | PVC      | Black  | 19mm x 0.216mm | 20m       |
| SCOTCH88-25 | PVC      | Black  | 25mm x 0.216mm | 33m       |
| SCOTCH88-38 | PVC      | Black  | 38mm x 0.216mm | 33m       |

## Scotch 22 Tape



**Extra heavy duty PVC tape**

### FEATURES

- Designed for heavy duty applications, harnessing, cable sheath repair and sealing connectors
- High elastic memory, excellent abrasion and puncture resistance
- All weather tape suitable for cold weather applications
- Flame retardant and highly conformable
- Excellent resistance to moisture, alkalis, acid, copper corrosion
- Conforms to BS 3924 and UL 510
- Temperature rating -10°C to +80°C

| Part Number | Material | Colour | Size           | Coil size |
|-------------|----------|--------|----------------|-----------|
| SCOTCH22-12 | PVC      | Black  | 12mm x 0.254mm | 33m       |
| SCOTCH22-19 | PVC      | Black  | 19mm x 0.254mm | 33m       |
| SCOTCH22-25 | PVC      | Black  | 25mm x 0.254mm | 33m       |
| SCOTCH22-38 | PVC      | Black  | 38mm x 0.254mm | 33m       |
| SCOTCH22-50 | PVC      | Black  | 50mm x 0.254mm | 33m       |





## Rail | Cable troughing

**In the rail industry, power and signalling cables often need protection from the environment, accidental damage or vandalism.**

Jointing Tech provide a full range of troughing systems that overcome any of these problems.

Whether it be ground level or elevated applications Jointing Tech can supply all your needs with fully PADS approved products encompassing off the shelf items available for immediate delivery or full project support for even the largest installations.

[www.jointingtech.co.uk](http://www.jointingtech.co.uk)

**THE POWER TO DELIVER**



## TroTrof

### FEATURES

- Lightweight cable trough weighing just 18kgs
- Has full Network Rail PADS approval, Certificate Number PA05/02512
- Both lid and base interact with concrete making it ideal for upgrade projects
- Over four times faster to install than the concrete alternative
- Complies with HSE manual handling guidelines
- Environmentally friendly made from recycled polymers.
- Dimensions C1/9
- Anti-Vandal/Anti-Theft features



| Part Number | Length | Width | Height | Weight |
|-------------|--------|-------|--------|--------|
| TROTROF     | 1000mm | 281mm | 206mm  | 18kg   |

### Transportation Comparison

|                            | TroTrof   | Concrete Trough                   |
|----------------------------|-----------|-----------------------------------|
| Units/Pallets              | 20        | 42 lids/pallet<br>24 bases/pallet |
| Transport for 960 units    | 1 truck   | 4.4 trucks                        |
| Transport for 10,000 units | 11 trucks | 44 trucks                         |

### Health & Safety Comparison

|                  | TroTrof        | Concrete Trough    |
|------------------|----------------|--------------------|
| Lifting          | One man lift   | Two men lift       |
| Cutting          | Standard tools | Petrol disc cutter |
| Dust/Noise       | No             | Yes                |
| Finish           | Smooth         | Abrasive           |
| Carbon Footprint | Medium         | High               |
| Recyclable       | Yes            | No                 |

## TroTred

### FEATURES

- Made up of 5 components, 44kg in total (max component weight 12kg)
- Has full network rail PADS approval, Certificate Number PA05/04103
- Doubles up as a walkway eliminating need for additional paths.
- Self-extinguishing and complies with Network Rail specifications
- Over four times faster to install than the concrete alternative
- Complies with HSE manual handling guidelines
- Environmentally friendly made from recycled polymers
- Anti-Vandal/Anti-Theft features

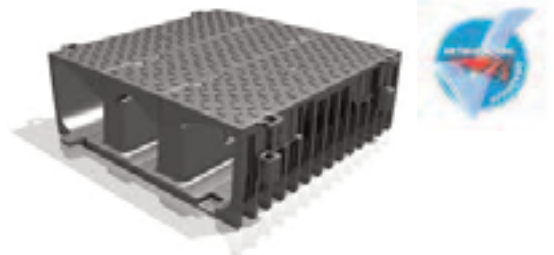

| Part Number | Length | Width | Height | Weight |
|-------------|--------|-------|--------|--------|
| TROTRED     | 1000mm | 736mm | 385mm  | 44kg   |

### Transportation Comparison

|                            | TroTrof          | Concrete Trough    |
|----------------------------|------------------|--------------------|
| Units/Pallets              | 4 complete units | 9 bases<br>15 lids |
| Transport for 1,000 units  | 5 trucks         | 10 trucks          |
| Transport for 10,000 units | 50 trucks        | 100 trucks         |

### Health & Safety Comparison

|                  | TroTrof        | Concrete Trough         |
|------------------|----------------|-------------------------|
| Lifting          | Two man lift   | 4 men/base<br>3 men/lid |
| Cutting          | Standard tools | Petrol disc cutter      |
| Dust/Noise       | No             | Yes                     |
| Finish           | Smooth         | Abrasive                |
| Carbon Footprint | Medium         | High                    |
| Recyclable       | Yes            | No                      |

## Hydraulic Press Head 10-400mm<sup>2</sup>

### FEATURES

- Hydraulic press head complete with quick release coupling to connect head to pump with max operating pressure of 700 bar
- Lightweight at only 3.8kg
- Compatible with a range of dies that accept Cu/Al lugs/splices and C tap connectors at LV and HV voltages
- Head compatible with both PO7000/B70-P24 and EP10 electric pump



**RHC 131 type hydraulic press head for 10-400mm<sup>2</sup> cables**

| Part Number   | Die Range | Conductor Size        |
|---------------|-----------|-----------------------|
| <b>RHC131</b> | ME-C      | 10-400mm <sup>2</sup> |

## Hydraulic Press Head 400-630mm<sup>2</sup>

### FEATURES

- Hydraulic press head complete with quick release coupling to connect head to pump with max operating pressure of 700 bar
- Lightweight at only 5.5kg
- Adaptor type AU230-130D is available as an optional extra enabling the head to utilise smaller ME-C, MA-C and PA-C dies
- Head compatible with both PO7000/B70-P24 and EP10 electric pump



**ECW-H3D type hydraulic press head for 400-630mm<sup>2</sup> cables**

| Part Number    | Die Range | Conductor Size         |
|----------------|-----------|------------------------|
| <b>ECW-H3D</b> | ME-3D     | 400-630mm <sup>2</sup> |

## Hydraulic Press Head 400-1000mm<sup>2</sup>

### FEATURES

- Hydraulic press head complete with quick release coupling to connect head to pump with max operating pressure of 700 bar
- Weight is 18kg
- Complete with two handles on either side of the head for ease of use
- Adaptor type AU520-130C is available as an optional extra enabling the head to utilise smaller ME-C, MA-C and PA-C dies
- Head compatible with both PO7000/B70-P24 and EP10 electric pump



**RHU-520 type hydraulic press head for 400-1000mm<sup>2</sup> cables**

| Part Number    | Die Range | Conductor Size          |
|----------------|-----------|-------------------------|
| <b>RHU-520</b> | ME-520    | 400-1000mm <sup>2</sup> |

## Outer Sheath Strippers

### FEATURES

- Can also be used for removal of primary insulation and lead alloy sheaths
- For circular and longitudinal cuts
- Fully insulated stripper available (PG3-EC)

| Part Number    | Sheath Diameter |
|----------------|-----------------|
| <b>PG2-HTA</b> | 21-35mm         |
| <b>PG3-HTA</b> | 26-51mm         |
| <b>PG3-EC</b>  | 26-51mm         |

| Part Number    | Sheath Diameter |
|----------------|-----------------|
| <b>PG4-HTA</b> | 47-75mm         |
| <b>PG5-HTB</b> | 65-95mm         |
| <b>PG6-HTB</b> | 80-125mm        |



**Outer sheath removal tool**

## Peelable Semi-Conductive Screen Stripper

### FEATURES

- The LHM tools allow simple and easy removal of peelable semi-conductor
- The tool works by creating a precise spiral incision with an offset circular blade on the semi-conductor which allows it to be neatly unwrapped
- The remaining length of exposed semi-con can be set depending on the tool used

| Part Number       | Diameter over Screen |
|-------------------|----------------------|
| <b>LHM1R30/45</b> | 14-40mm              |
| <b>LHM2R30/60</b> | 38-60mm              |



**For use on easy peel cable screens**

## Pre-set Scoring Tool

### FEATURES

- Two different tools for use at either 11 or 33kV
- Pre-set blade depth allows easy scoring and screen removal

| Part Number     | Diameter | Use with |
|-----------------|----------|----------|
| <b>TT2352/1</b> | 0.4mm    | For 11kV |
| <b>TT2352/2</b> | 0.6mm    | For 33kV |



**For use on easy peel cable conductive screens**

## Bonded Screen Removal Tool

### FEATURES

- This tool enables the user to remove and chamfer the bonded semiconductor in a clean and swift manner without the use of silicon
- The blade is adjustable from 0.4mm to 1.4mm with "clicking knob" (0.1mm for each click)
- The angle of the chamfer is 8°
- Tool will accommodate insulation

| Part Number     | Diameter over Screen |
|-----------------|----------------------|
| <b>CWB18-60</b> | 18-60mm              |

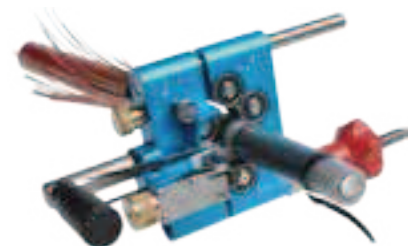

**For removal and chamfer of bonded screen**

## Toolout Hire

### FEATURES

- Jointing Technologies have the largest hire fleet of crimping and cutting tools in the country
- All available on a next working day delivery (on orders placed before 4pm)
- All tools are calibrated and checked prior to dispatch to ensure they are in full working order

### Hydraulic Crimping



### FEATURES

- Also available in hand tool version
- Dies available 10-1000mm<sup>2</sup> copper/aluminium LV/HV
- Please state cable type and size

### Hydraulic Cutting



### FEATURES

- Also available in hand tool version
- TC120 cutting head - max cutting diameter of 120mm
- HT-TC085 cutting hand tool - max cutting diameter of 85mm

### Battery Crimping



### FEATURES

- Dies available 10-1000mm<sup>2</sup> copper/aluminium LV/HV
- Please state cable type and size

### Battery Cutting



### FEATURES

- TC120 cutting head - max cutting diameter of 120mm

### Hydraulic Crimp & Cut



### FEATURES

- Dies available 10-1000mm<sup>2</sup> copper/aluminium LV/HV
- TC120 cutting head - max cutting diameter of 120mm
- Please state cable type and size

### Battery Crimp & Cut



### FEATURES

- Dies available 10-1000mm<sup>2</sup> copper/aluminium LV/HV
- TC120 cutting head - max cutting diameter of 120mm
- Please state cable type and size

### FEATURES

- Long term hire deals available - Please contact our sales department for further information
- All hire prices include die sets - to ensure the correct sizes are supplied please advise at time of order
- Dies are available for copper and aluminium cables, C-taps and elbow contacts

### Cable Spiking Tool

#### FEATURES

- Used for spiking power cables prior to jointing, terminating or repair



### Pfisterer Tool

#### FEATURES

- Standard size 1, 2, 3 tool
- Larger sizes 4-5S and 6 also available on request



### Cable Jack & Spindle



#### FEATURES

- Both 3 or 6 ton versions available
- Due to size and weight additional carriage may apply on this item. Contact your local sales office for more information

### TDUX Duct Seal Inflation Tool



#### FEATURES

- Complete with pressure gauge to ensure correct installation
- Please order gas separately - see page 200

### Tool Repair & Calibration

#### FEATURES

- Cembre and Prysmian approved repairer
- Calibration certificates supplied
- Estimates provided prior to works
- Reconditioned tools available
- All tools must be calibrated after each hire to comply with BS7671 (UK Wiring Regulations)



## Miscellaneous Consumables

A wide range of fixings are available, some of which are listed below.

For our complete range visit us online at <https://www.jointingtech.co.uk/Power-Consumables>

| Product                           | Image   | Part Number  | Details  | Description   |
|-----------------------------------|---|--|--|---|
| <b>Padlock</b>                    |    | 1030006813   | 30mm   | PADS Approved Armoured Padlock:<br>High security padlock<br>Keyed differently   |
| <b>Keys</b>                       |   |  |  | PADS Approved Key   |
| <b>Wipes</b>                      |    | JT250  | 250 wipes  | Cable Cleaning Wipes<br>High performance residue free solvent cleaning<br>wipes for cable cleaning prior to jointing, termi-<br>nating and for kitting of cables                  |
| <b>Banner Fencing</b>             |   |  |  |   |
| <b>Unial Jointing Paste</b>       |    | UNIAL  | 250g   | Electrical jointing compound that prevents<br>corrosion in joints and enhances electrical<br>connections.   |
| <b>Concrete Inspection Pit</b>    |   | Furse code:<br>PT005<br>Wallis code:<br>ERH02W           | 30kg   | Designed to provide access to the earth rod<br>assembly for periodic testing<br>Load rated to 3,500kg   |
| <b>Lightweight Inspection Pit</b> |  | Furse code:<br>PT205<br>Wallis code:<br>EPP002W          | 1.80kg   | Lightweight, heavy duty inspection pit with<br>unique design including lockable lid<br>Manufactured from high performance polymer,<br>a UV stable & chemically resistant material |
| <b>Tape Tile</b>                  |  | TILE 152-12<br>TILE 244-12<br>TILE 300-12<br>TILE 450-12 | 12mm x 152mm x 1m<br>12mm x 244mm x 1m<br>12mm x 300mm x 1m<br>12mm x 450mm x 1m | High level cable protection that provides clear<br>warning to third parties<br>Lightweight and easy to install  |
| <b>1 Tonne Waste Bags</b>         |  | 746501   |  | Single trip 1 tonne waste bags in woven poly-<br>propylene  |
| <b>Hazardous Waste Bags</b>       |  | 22163K   | 75 x 100cm / 125 micron with tie   | Darcy Spillcare yellow hazardous waste bags   |



## Fixings

A wide range of fixings are available, some of which are listed below.

For our complete range visit us online at <https://www.jointingtech.co.uk/Power-Consumables>

| Nuts                                    | Image   | Part Number  | Details  | Description  |
|---|---|--|--|--|
| <b>Hex Head Brass Nuts</b>              |    | P601-992<br>P601-994<br>P601-100<br>P601-300<br>P601-400<br>P601-500<br>P601-600   | 2BA<br>4BA<br>M4<br>M6<br>M8<br>M10<br>M12   | Perfect for bolting products<br>Various sizes available  |
| <b>Hex Head Full Steel BZP Nuts</b>     |    | N011-300<br>N011-400<br>N011-500<br>N011-600<br>N011-700<br>N011-800   | M6<br>M8<br>M10<br>M12<br>M16<br>M20   | Hex full nuts are ready for use with other bolting products on site<br>Various sizes available |
| <b>Hex Head Stainless Steel Nuts</b>    |    | P011-300<br>P011-400<br>P011-500<br>P011-600<br>P011-700   | M6<br>M8<br>M10<br>M12<br>M16  | Ideal for bolting products<br>Various sizes available  |
| Bolts                                   | Image   | Part Number  | Details  | Description  |
| <b>Brass Hex Head Full Thread Bolt</b>  |   | P701-310<br>P701-312<br>P701-315<br>P701-320<br>P701-410<br>P701-412<br>P701-415<br>P701-420<br>P701-510<br>P701-512<br>P701-515<br>P701-520<br>P701-525<br>P701-612<br>P701-615<br>P701-620<br>P701-625<br>P701-635 | M6 X 20MM<br>M6 X 25MM<br>M6 X 30MM<br>M6 X 40MM<br>M8 X 20MM<br>M8 X 25MM<br>M8 X 30MM<br>M8 X 40MM<br>M10 X 20MM<br>M10 X 25MM<br>M10 X 30MM<br>M10 X 40MM<br>M10 X 50MM<br>M12 X 25MM<br>M12 X 30MM<br>M12 X 40MM<br>M12 X 50MM<br>M12 X 70MM | Used for a variety of assemblies<br>Call for full range of sizes                               |
| <b>Hex Head BZP Bolts</b>               |  | N501-310<br>N501-430<br>N501-512<br>N501-530<br>N501-550<br>N501-637<br>N501-720<br>N501-740<br>N501-825   | M6 X 20MM<br>M8 X 60MM<br>M10 X 25MM<br>M10 X 60MM<br>M10 X 100MM<br>M12 X 75MM<br>M16 X 40MM<br>M16 X 80MM<br>M20 X 50MM  | Huge range available, contact your local branch for all options                                |
| <b>Stainless Steel A2 Hex Head Bolt</b> |  | P351-308<br>P351-412<br>P351-530<br>P351-612<br>P351-630<br>P371-750   | M6 X 16MM<br>M8 X 25MM<br>M10 X 60MM<br>M12 X 25MM<br>M12 X 60MM<br>M16 X 100MM  | Wide range available, contact your local branch for all options                                |

## Fixings

A wide range of fixings are available, some of which are listed below.

For our complete range visit us online at <https://www.jointingtech.co.uk/Power-Consumables>

| Washers                         | Image   | Part Number   | Details                                | Description   |
|---------------------------------|---|---|--|---|
| <b>Sealing Washers - Fibre</b>  |    | 41702-53<br>41702-55<br>41702-56<br>41702-57<br>41702-59<br>41702-61<br>41702-63        | 20<br>25<br>32<br>40<br>50<br>63<br>75 | High performance sealing washers<br>Improves the IP & rating between the gland and the equipment<br><br>Fibre to BS6091 Pt1 |
| <b>Sealing Washers - Nylon</b>  |    | 25111-003<br>25111-005<br>25111-006<br>25111-007<br>25111-009<br>25111-011<br>25111-013 | 20<br>25<br>32<br>40<br>50<br>63<br>75 | Nylon 6.6   |
| <b>Square Plate Washers</b>     |    | P1019<br>P1020  | M10 HOLE<br>M12 HOLE                   | Various sizes available   |
| Brackets                        | Image   | Part Number   | Details                                | Description   |
| <b>Flat Plate Metal Bracket</b> |   | P1067   |  | 4 hole galvanised metal bracket tailored specifically for use in cable management support systems                           |
| <b>Flat 90 Degree Elbow</b>     |  | P1036   |  | 3 hole galvanized metal bracket designed for use in cable management systems  |
| <b>90 Degree Angle Tee</b>      |  | P1033   |  | Designed specifically for use with cable management support systems   |
| <b>Flat Tee</b>                 |  | P1031   |  | 4 hole galvanized metal bracket.  |
| <b>Wing Bracket</b>             |  | P2223   |  | 4 hole wing shape ninety degree fitting corner bracket  |
| <b>Z Shaped Bracket</b>         |  | MSZ701<br>MSZ700  | P1045 41mm<br>P4045 21mm               | Two sizes available<br>Specially deigned for use in cable management systems  |

## ● **PRICING**

Prices are subject to discount where applicable and are quoted exclusive of VAT.

All prices listed are correct at time of publication however Jointing Tech reserves the right to amend such pricing without notice when prevailing circumstances dictate that such action is required.

## ● **CARRIAGE**

Jointing Tech provides a carriage paid, next day service to all mainland U.K. customers for all in stock orders over £150.00 nett received and processed by 4.00pm.

If the customer requires a timed delivery or any special delivery requirements Jointing Tech reserves the right to pass on the additional cost of any such services. All orders from customers outside mainland U.K. will be subject to an additional carriage charge.

A minimum order charge of £10.00 is levied on all order below £150.00 to cover the cost of the carriage.

Jointing Tech are not responsible for consequential damages due to late delivery or in circumstances beyond our control.

## ● **DISCOUNT**

Any preferential discounts applicable to prices shown in this catalogue will be advised at quotation stage or at time of ordering.

## ● **RETURNS POLICY**

Jointing Tech will not accept goods that have been supplied correctly back for credit without prior agreement by an authorised member of staff. Such items must be returned in the original packaging and in a saleable condition, but Jointing Tech reserves the right to enforce a handling charge where deemed appropriate. Where goods have been dispatched direct by a manufacturer to the client, and that manufacturer places a returns charge on ourselves, we reserve the right to pass on any such charges. Please note LV heatshrink sleeving cut from a spool cannot be returned.

Any credits applicable will not be raised until the goods have been returned to us and been inspected. Any errors in supply by Jointing Tech must be notified to us within 14 days of receipt of the goods.

## ● **HIRE CHARGES**

All hire charges will be calculated from the delivery date of the goods and will be levied on a weekly or daily basis quoted at the time of order. Such charges will continue to be levied until such time as the client receives an Off Hire Number from Jointing Tech.

## ● **DAMAGED OR LOST EQUIPMENT**

All tooling is checked and calibrated before dispatch and also on return. Where such tooling is returned in a damaged condition due to misuse, Jointing Tech reserve the right to pass on all repair costs to the hirer. Any lost tooling will be charged to the client at the FULL replacement cost.

## ● **SELECTION CHARTS**

Jointing Tech have reproduced all selection guides within this catalogue in good faith and with the consent of the manufacturers. All information should be used as a guide only and where applicable actual dimensions on cables etc may be required at time of ordering.

Jointing Tech will not be held responsible for any error in selection derived from the information used in this catalogue

## ● **FULL TERMS & CONDITIONS ARE AVAILABLE ON REQUEST**





# Jointing Tech

## Jointing Tech Branches:

### Woking

Unit 19  
Woking Business Park  
Albert Drive  
Woking  
GU21 5JY

Tel: 01483 747747

### Bristol

The Alpha Centre  
Armstrong Way  
Great Western Business Park  
Yate  
Bristol  
BS37 5NG

Tel: 01454 322555

### Norton Canes

Unit 15-16  
Bellsizes Close  
Norton Canes  
Staffordshire  
WS11 9TQ

Tel: 01543 450555

## Quality and Industry Accreditation



## Jointing Tech Group:

### Langley Engineering Ltd

16 The Markham Centre  
Theale  
Reading  
Berkshire  
RG7 4PE

Tel: 0118 930 5990

### Jointing Tech – Trace Heating Division

Unit 4 Eversley Way  
Thorpe Industrial Estate  
Egham  
Surrey  
TW20 8RG

Tel: 01784 279005

Jointing Technologies is part of Toolout Limited.  
© Toolout Limited. All rights reserved.  
Registered in England. Company Number 2281668

[www.jointingtech.co.uk](http://www.jointingtech.co.uk)

