

Stainless Steel Single Cleat TSC Series

In all cable installations, an essential factor is to ensure that all cables are secured with the correct cleats for the cable, application, and environment. The TSC series of cleats support and secure all cables throughout the system during normal operation and during fault conditions that may

occur. System integrity is maintained and cable damage can be prevented.

All cleats in the TSC series comply with the requirements of IEC 61914 : 2009. The cleat body and fastenings are manufactured from 316L corrosion resistant non magnetic stainless steel which makes them suitable for use within harsh and extreme environments including marine and offshore applications. The main cleat fastening bolts are retained to ease installation. This style of cleat gives a wider range take of cables than conventional hinged cleats. The cleat liner is manufactured from an extruded polymer which is an LUL approved flame retardant halogen free polymer material. Cleats can also be supplied, as an addition, with an easy fit spacer plate to further the size range take.

Correct cleat spacing for all cables is extremely important and many factors must be considered. All recommendations from the cable manufacturer must be followed. For correct cleat spacing recommendations please contact our technical department.

Test Standard BS EN 61914:2009 (IEC 61914)		
	Clause	Classification
Type	6.1.3	Composite
Operating Temperature	6.2	-45°C to +120°C
Impact Resistance	6.3	V. Heavy
Needle Flame	10.1	>120 secs

	Clause	Classification
Resistance to short circuit	6.4.3 1 short circuit	80kA RMS, 176kA Pk
	6.4.4 2 short circuits	70kA RMS, 154kA Pk
Corrosion	6.5.2	High , Outdoor - wet conditions
Spacing	As cleat spacing is dependent on system fault level and cable diameter then please enquire with cleat manufacturer for correct maximum cleat spacing, for the system design.	

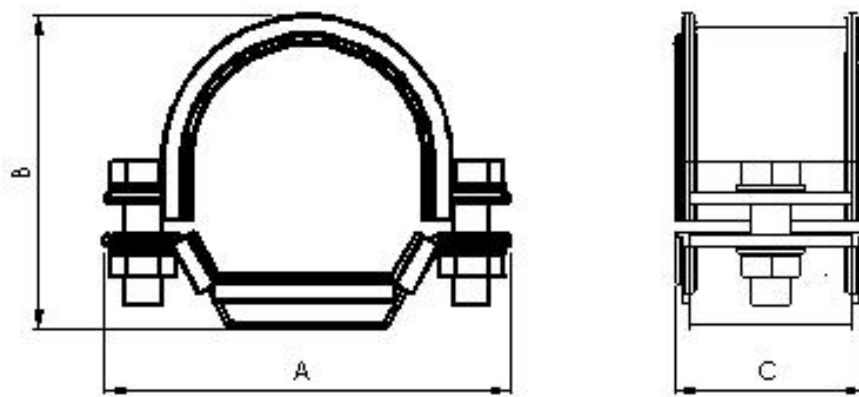

Cleat Reference Number	Cable Ø	Cable Ø	Cleat Details		
	Minimum	Maximum	A	B	C
TSC2429	24	29	84	65	64
TSC2732	27	32	91	74	
TSC3036	30	36	98	83	
TSC3441	34	41	105	92	
TSC3947	39	47	113	104	
TSC4554	45	54	122	117	
TSC5062	50	62	135	132	
TSC6072	60	72	148	150	
TSC6880	68	80	155	166	
TSC7895	78	95	256	194	120
TSC93110	93	110	288	221	
TSC105126	105	126	322	251	
TSC122146	122	146	365	288	
TSC142170	142	170	417	333	
Customised sizes: Special projects or customised cleat sizes can be manufactured upon request. The product code is constructed as follows: (T = 2 bolt)(S = Single)(C = Cleat) (xxx = nominal cable diameter)(% = range take) Examples: For a special single cleat to fit cable 83 diameter cable with a +/- 5% range take (79mm to 87mm) then the product code would be TSC08305. For a special single cleat to fit cable 97 diameter cable with a +/- 4% range take (94mm to 100mm) then the product code would be TSC09704. For a special single cleat to fit cable 55 diameter cable with a +/- 7% range take (51mm to 59mm) then the product code would be TSC05507. Please note for special projects the maximum % range take is +/- 7% on any nominal cable diameter					
All cleats have a single fixing point in the cleat base.					

Features

- Low, Medium and High Voltage single core cables with high fault current capacities.
- Cable Diameters from 24mm to 170mm
- Can be used in harsh environments including marine and offshore.
- Suitable for use with all standard ladder and tray systems.
- Operating temperatures -45°C to +120°C