

ITEM	PART/DRG NO	QTY	DESCRIPTION
1	01-500-0013	1	BRASS CNE CONNECTORS PRESSURE PLATE
2	01-500-0014	1	BRASS CNE CONNECTOR SHOE
3	01-500-0067	1	BRASS CNE END TERMINATION BODY - TYPE 3 WITH M10 BOTTOM & SIDE HOLES
4	01-701-0038	1	M12 x 1.75 13 A/F 52.5 LONG BRASS MULTI-SHEAR BOLT

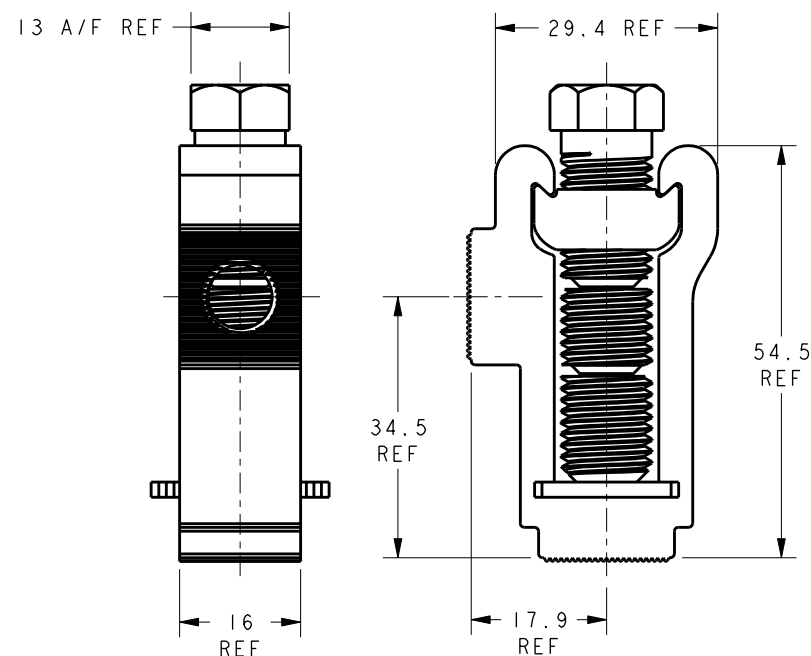

NOTES :

1. CONNECTOR IS TO BE SUPPLIED ASSEMBLED AS SHOWN. SHEAR BOLT IS TO BE SCREWED THROUGH SHOE UNTIL PRESSURE PLATE IS PUSHED AGAINST CONNECTOR BODY (HAND TIGHT ONLY) ALLOWING SHEAR BOLT, SHOE AND PRESSURE PLATE TO BE FIXED IN POSITION WITHIN CONNECTOR BODY.

2. APPROX PART WEIGHT = 150.20g



Material	VARIES
Finish	VARIES
Tolerances (UOS)	N/A
B&H Short Desc.	BTCNE3UTB/BSM10/A

Part Description
**BRASS CNE END TERMINATION - TYPE 3
 WITH M10 BOTTOM & SIDE HOLES
 & MULTI-SHEAR BOLT (ASSEMBLED)**

- IF IN DOUBT ASK - DO NOT SCALE -

REMOVE ALL BURRS AND SHARP EDGES - SURFACES TO BE FREE FROM SCRATCHES AND DEFECTS - ALL THREADS TO BS3643 PT 2

D	PICTORIAL CHANGES TO BAH-015000067 - SERRATIONS ADDED	BH-00873	08/04/13
C	BAH-015000088 (x1) & BAH-025000094 (x1) REMOVED AND REPLACED WITH BAH-015000013 (x1), BAH-015000014 (x1), BAH-015000067 (x1) & BAH-017010038 (x1)	BH-00842	06/12/12
B	BAH-015000013 (x1), BAH-015000014 (x1), BAH-015000067 (x1) & BAH-017010038 (x1) REMOVED AND REPLACED WITH BAH-015000088 (x1) & BAH-025000094 (x1)	BH-00746	16/04/12
A	FIRST ISSUE	BH-00061	03/06/05
Revision	Description	Name/DMR	Date
Design/Drawn	D M EATON	Date	01-Jun-05
PCN/RPN No	E84084-000	Scale (UOS)	1:1
Drawing/Part No	BAH-025000068	Checked/Approved by	
Drawing Type	ASSEMBLY/CUSTOMER	THIRD ANGLE PROJECTION	A4
Rev	D		

© 2013 TYCO ELECTRONICS UK LTD, WITHAM, UK