



Stainless Steel Quad Cleat / Strap SQC / SQS Series

In all cable installations, an essential factor is to ensure that all cables are secured with the correct cleats for the cable, application, and environment. The SQC / SQS series of cleats and straps support and secure all cables in quadrafoil formation throughout the system during normal operation and during fault conditions that may occur. System integrity is maintained and cable damage can be prevented.

All cleats in the SQC / SQS series comply with the requirements of IEC 61914 : 2009. The cleat body and fastenings are manufactured from 316L corrosion resistant non magnetic stainless steel which makes them suitable for use within harsh and extreme environments including marine and offshore applications. The main cleat fastening bolt is retained to ease installation.

The cleat liner is manufactured from an extruded polymer which is an LUL approved flame retardant halogen free polymer material. Cleats are supplied with an easy fit spacer plate to assist with range take
Correct cleat spacing for all cables is extremely important and many factors must be considered. All recommendations from the cable manufacturer must be followed. For correct cleat spacing recommendations please contact our technical department.

Test Standard	BS EN	
61914:2009	(IEC 61914)	
	Clause	Classification
Type	6.1.3	Composite
Operating Temperature	6.2	-45°C to +120°C
Impact Resistance	6.3	V. Heavy
Needle Flame	10.1	>120 secs

	Clause	Classification
Resistance to short circuit	6.4.3 1 short circuit	60kA RMS, 132kA Pk
	6.4.4 2 short circuits	50kA RMS, 110kA Pk
Corrosion	6.5.2	High , Outdoor - wet conditions
Spacing	As cleat spacing is dependent on system fault level and cable diameter then please enquire with cleat manufacturer for correct maximum cleat spacing, for the system design.	

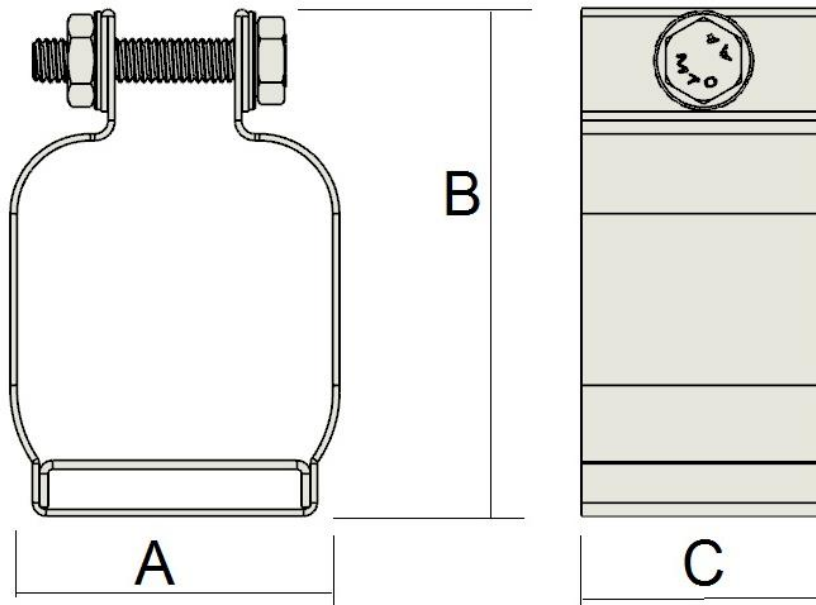

Trefoil Reference Number	Cable Ø Minimum	Cable Ø Maximum	Cleat Details			
			A	B	C	D
SQC 2325	23	25	62	92	64	Single hole
SQC 2627	26	27	66	96		
SQC 2831	28	31	72	104		
SQC 3135	31	35	82	112		
SQC 3642	36	42	98	126		
SQC 4347	43	47	112	136		
SQC 4751	47	51	118	144		
SQC 5157	51	57	129	156		
SQC 5763	57	63	138	168		
SQC 6370	63	70	152	182		
Cleats have a single central fixing hole for a 10mm dia fixing bolt.						

Features

- Low, Medium and High Voltage single core cables in Quad formation.
- Can also be supplied for single and trefoil format if required
- Cable Diameters from 23mm to 70mm
- Can be used in harsh environments including marine and offshore.
- Suitable for use with all standard ladder and tray systems.
- Operating temperatures -45°C to +120°C