

Two Bolt Aluminium Cable Cleats

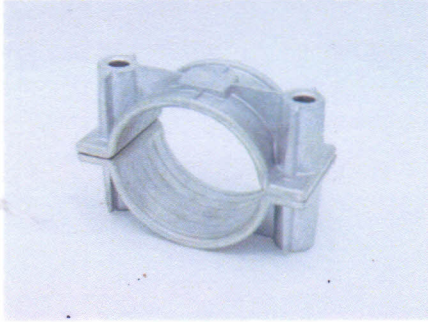

Specification: EN 50368:2003

Cleat Type: 6.1,6.1.3, Metallic

Needle Flame Test: > 120 seconds passed

Lateral Load Test: 28000N

Temperature Range: -50°C to +150°C

The two-bolt fixing aluminium cleat features unique flanges alongside the fixing turrets to enable a firm fixing to cable ladder rungs or conventional steel channel systems, preventing the rocking feature of some competitors products.

Designed for direct fixing onto ladder or channel support structures and requiring no additional special adaptor plates or packing pieces, only being subject to environment considerations where 91-ST cleat separation washers should be used.

Available as standard in plain aluminium alloy (LM6 grade) to BS1490, suitable for normal industrial use or outdoor, un-polluted environments, the product can also be supplied with a variety of protection coatings to order, e.g. epoxy.

Some sizes feature the same bolt-fixing centres which can enable different sizes to be easily stacked.

Order Reference	Cable Outside Diameter Range	Cleat Width	Cleat Height	Cleat Depth	Fixing Centre	Fixing Hole	Safe Working Load (kgs)	Weight (grams)
SW2B10	51.0-57.0	96	68	49	76	2xM10	1600	207.6
SW2B11	57.0-64.0	96	75	49	76	2xM10	1600	220
SW2B12	64.0-70.0	134	84	64	114	2xM10	1600	375.8
SW2B13	70.0-76.0	134	90	64	114	2xM10	1600	392.2
SW2B14	76.0-83.0	142	96	64	114	2xM12	1600	450.6
SW2B15	83.0-89.0	142	102	64	114	2xM12	1600	550
SW2B16	89.0-95.0	154	114	76	126	2xM12	1600	650
SW2B17	95.0-101.0	154	120	76	126	2xM12	1600	750
SW2B18	101.0-108.0	169	134	76	140	2xM12	1600	1100
SW2B19	108.0-114.0	169	140	76	140	2xM12	1600	1120
SW2B20	114.0-120.0	174	144	76	145	2xM12	1600	1140

Technical Data	Properties:	BS EN 50368:2003	Unit Classification
		Classification Clause	
	Cleat Type:	6.1 & 6.1.3	Metallic
	Impact Resistance:	6.2, 6.2.5 & 9.3	>6.5kg @ 300mm
	Temperature Range:	6.4	-40°C to +150°C
	Needle Flame Test:	6.5 & 10.0	>120 seconds
	Lateral Load Test:	9.2	28000N
	Axial Movement Test:	9.5	2000N

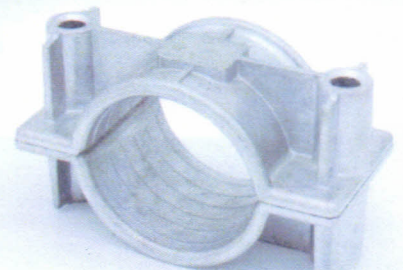

Selection Guide For XLPE/SWA/LSF or PVC 600/1000v cables

Cores	150mm ²	185mm ²	240mm ²	300mm ²	400mm ²
2 core	-	-	-	2ALM10	2ALM10
3 core	-	2ALM10	2ALM10	2ALM11	2ALM12
4 core	2ALM10	2ALM10	2ALM11	2ALM12	2ALM13