

REVISIONS

P	LTR	DESCRIPTION	DATE	DWN	APVD
	D	REDRAWN IN CREO	16AUG2021	VF	EFG

LINE TERMINATION M12 NICKEL
PLATED BRASS FITTED WITH
2-NICKEL PLAYTED BRASS LOCKNUTS

MOULDED RESIN
INSULATOR

HERMETICALLY SEALED
GLASS DISPLAY PANEL

M12x35 GALVANISED
STEEL SET SCREW
WITH FULL NUT AND
SPRING WASHER

GROUND TERMINATION M12 NICKEL
PLATED BRASS FITTED WITH
2-NICKEL PLATED BRASS LOCKNUTS

FLYING-LEAD
CABLE GLAND AND 2-CORE CABLE
0.5 m LENGTH FROM AUXILIARY CONTACTS
RATED 1 A 250 V AC OR DC

MAX TIGHTENING TORQUE FOR CONNECTIONS AND MOUNTINGS 40 Nm

COUNTER CASE OF DIE CAST SILICON ALUMINIUM EPOXY POWDER COATED

METER SCALE SHOWN IS TYPICAL ONLY

PROTECTION CLASSIFICATION IP 67

WEIGHT 2.8 kg APPROX.

ALL DIMENSIONS NOMINAL
UNLESS SPECIFIED

THIS DRAWING IS A CONTROLLED DOCUMENT.

DIMENSIONS:
mm

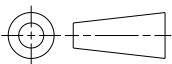

TOLERANCES UNLESS
OTHERWISE SPECIFIED:

0 PLC ±-
1 PLC ±-
2 PLC ±-
3 PLC ±-
4 PLC ±-
ANGLES ±-

MATERIAL

-

FINISH

-

DWN 16AUG2021

V.FUZETTI

CHK 16AUG2021

E.F.GASTALDI

APVD 16AUG2021

S.A.KUMAR

PRODUCT SPEC

-

APPLICATION SPEC

-

WEIGHT

NOTE

CUSTOMER DRAWING

CJ2984-000

PART NO.



TE Connectivity

NAME

SURGE ARRESTER TYPE:
SC13-AC

SIZE

A3

CAGE CODE

00779

DRAWING NO

C=LA-17004

RESTRICTED TO

-

SCALE

NTS

SHEET

1 OF 1

REV

D