



Telcleat® 385 series

- Suitable for use with cable diameters 10 to 51mm.
- Manufactured from Low Density Polythene.
- Overlapping self-adjusting ranges.
- Sunlight (UV) and weather resistant.
- One piece, single fixing design.
- Can be double stacked on a single fixing.
- Operating temperature -40°C to +60°C.
- Tested in accordance with BS EN 50368.

Technical Data

| Cable and Cleat Selection | | | | Cleat Details | | | | | | |
|---------------------------|--------------------------|------|-----------------------------|-----------------|-----|-----|----|------------|---|------------------------------------|
| Design Number | Cable Diameter A (mm) | | Standard Pack Quantities | Dimensions (mm) | | | | Weight (g) | Roundhead woodscrew masonry, concrete or wood M5 x No | Screw Bolt for Cable Tray mm |
| | Min | Max | | Min | Max | Max | D | | | |
| 385AA01 | 10.5 | 14.5 | 100 | 15 | 18 | 32 | 12 | 2.3 | 1 ^{1/4} x 8 | M4 x 30 |
| 385AA02 | 12.2 | 16.7 | 100 | 17 | 22 | 36 | 14 | 3.4 | 1 ^{1/2} x 8 | M4 x 35 |
| 385AA03 | 14.6 | 19.8 | 100 | 21 | 26 | 43 | 16 | 5.5 | 1 ^{3/4} x 8 | M4 x 40 |
| 385AA04 | 17.7 | 24.0 | 50 | 25 | 31 | 51 | 18 | 8.6 | 2 x 8 | M4 x 45 |
| 385AA05 | 21.7 | 28.5 | 25 | 30 | 37 | 57 | 20 | 12.4 | 2 ^{1/4} x 12 | M6 x 50 |
| 385AA06 | 26.2 | 34.2 | 25 | 35 | 43 | 65 | 22 | 16.4 | 2 ^{1/2} x 12 | M6 x 60 |
| 385AA07 | 31.9 | 41.6 | 10 | 42 | 52 | 78 | 25 | 24 | 2 ^{3/4} x 12 | M6 x 70 |
| 385AA08 | 39.3 | 51.1 | 10 | 50 | 62 | 91 | 26 | 35 | 3 ^{1/4} x 12 | M6 x 80 |

Method of Fixing

The cleat is opened up and placed around the cable so that the end of the cleat containing the slot will be in contact with the mounting surface, except for the 385AA01, which should be reversed to put the slot uppermost. In this case an M5 washer should be used to prevent the nut entering the slot of the cleat.

When mounting directly on channel section an adaptor plate should be used (please see page 39).

Performance Data

| Test Standard | EN 50368:2003 |
|-------------------|-------------------------------|
| Type | 6.1.2 Non-Metallic |
| Impact Resistance | 6.2.4 Heavy -> 6.2.5 V. Heavy |
| Lateral Load | 0.188 -> 0.775 kN |
| Axial Load | 0.046 -> 1.118 kN |
| Needle Flame | >60 secs |

* Technical Information subject to change without notice

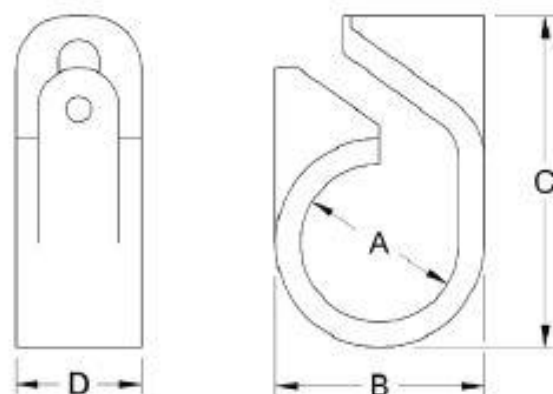



Afumex Telcleat® (LSOH) 385 series

- Suitable for use with cable diameters 10 to 51mm.
- Manufactured from LSOH polymer.
- Designed for use with Afumex LSOH and Saffire OHLS cables.
- Overlapping self-adjusting ranges.
- Sunlight (UV) and weather resistant.
- One piece, single fixing design.
- Can be double stacked on a single fixing.
- Operating temperature -40°C to +40°C.
- Tested in accordance with BS EN 50368.
- LUL approved product register ID 1259.

Technical Data

Afumex SAFFIRE^{OHLS}

| Cable and Cleat Selection | | | | Cleat Details | | | | | | |
|---------------------------|--------------------------|------|-----------------------------|-----------------|-----|-----|----|------------|--|------------------------------------|
| Design Number | Cable Diameter A (mm) | | Standard Pack Quantities | Dimensions (mm) | | | | Weight (g) | Roundhead woodscrew masonry, concrete or wood Ins x No | Screw Bolt for Cable Tray mm |
| | Min | Max | | Min | Max | Max | D | | | |
| 385LSF01 | 10.5 | 14.5 | 100 | 15 | 18 | 32 | 12 | 3.3 | 1 1/4 x 8 | M4 x 30 |
| 385LSF02 | 12.2 | 16.7 | 100 | 17 | 22 | 36 | 14 | 5.6 | 1 1/2 x 8 | M4 x 35 |
| 385LSF03 | 14.6 | 19.8 | 100 | 21 | 26 | 43 | 16 | 9.5 | 1 3/4 x 8 | M4 x 40 |
| 385LSF04 | 17.7 | 24.0 | 50 | 25 | 31 | 51 | 18 | 14.7 | 2 x 8 | M4 x 45 |
| 385LSF05 | 21.7 | 28.5 | 25 | 30 | 37 | 57 | 20 | 20.4 | 2 1/4 x 12 | M6 x 50 |
| 385LSF06 | 26.2 | 34.2 | 25 | 35 | 43 | 65 | 22 | 29.2 | 2 1/2 x 12 | M6 x 60 |
| 385LSF07 | 31.9 | 41.6 | 10 | 42 | 52 | 78 | 25 | 36.7 | 2 3/4 x 12 | M6 x 70 |
| 385LSF08 | 39.3 | 51.1 | 10 | 50 | 62 | 91 | 26 | 58.1 | 3 1/4 x 12 | M6 x 80 |

Method of Fixing

The cleat is opened up and placed around the cable so that the end of the cleat containing the slot will be in contact with the mounting surface, except for the 385LSF01, which should be reversed to put the slot uppermost. In this case an M5 washer should be used to prevent the nut entering the slot of the cleat.

When mounting directly on channel section an adaptor plate should be used (please see page 39).

Performance Data

| Test Standard | EN 50368-2003 |
|-------------------|-------------------------------|
| Type | 6.1.2 Non-Metallic |
| Impact Resistance | 6.2.4 Heavy -> 6.2.5 V. Heavy |
| Lateral Load | 0.136 -> 0.781 kN |
| Axial Load | 0.119 -> 1.024 kN |
| Needle Flame | >120 secs |

* Technical information subject to change without notice

